

Anthro Mobile Device Charging Carts and Cabinets Owners' Manual

Hello! Thank you for choosing Anthro.



These units are listed as UL Information Technology Equipment 60950-1 safety standard. AC input: 120VAC 60 Hz. Max amps: 12A. Charging Carts and Cabinets are designed to sync, charge, and store your devices safely and efficiently.

Please review this manual before installing your equipment to learn how to use the cart safely.

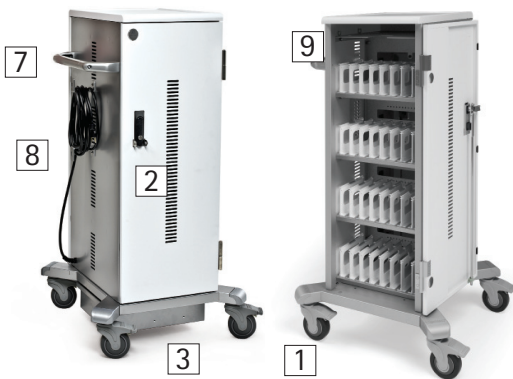

Table of Contents

Call-outs	1
Getting Started	2
Safety Notices	2
Trouble-shooting Guide	3
Cabinet Installation	4
Warranty	7

Components at a Glance

1. 4" Total-lock Casters
2. Locking Door Latch w/padlock mount
3. Storage Drawer (optional)
4. External Power Receptacles (3)
5. Power Indicator Light
6. Power Switch
7. Handle
8. Cord Wrap w/Power Cord
9. Laptop Storage Cubby



Charging Carts
 Convenience Outlets and
 Power Switch

Cabinet Parts Kit

Parts	Qty	Part Number
1-5/8" Screw	4	325-5086-00
Label Set - Shelf Numbers (1-40)	1	725-5106-00
Toggler Drywall Anchor	4	325-5394-00
3.5" Bolt	2	325-5657-00
Washer	2	325-5379-00
Nut	2	325-5259-00
1-5/8" Screw	4	325-5086-00
Rubber Feet	4	581-5063-00
Screws for Rubber Feet	4	325-5575-00
Anthro driver (5/32" hex)	1	375-5000-00

To see installation instructions for the Tablet Cabinet (TAB20SS/PW) and the Minitouch Cabinet (MCAB40SS/PW), turn to page 4.

Getting Started

Electrical Testing

- Before using your new charging cart or cabinet, have a qualified electrician verify the current draw does not exceed the rating of the unit when all the devices are installed.
- Test the contact integrity of the wall outlet using a receptacle tension tester such as a Woodhead 1760 or a Safeplug 1700.
- Test the branch circuit for ground integrity and branch circuit protection.
- Do not plug in the unit if the switch, receptacles, or power cord have been damaged or if the ground prong is missing from the plug. If repairs are ever needed, they should be performed by a qualified electrician.

Important Safeguards – We want you to be safe!

These carts and cabinets are electrical devices. Use care with them and follow these important safeguards:

- Electrical devices are not toys. Children are often unaware of the hazards associated with electrical devices, so this unit must always be used by adults or with adult supervision.
- Do not use this unit outdoors.
- Liquids should not be stored in, set on or placed inside this unit.
- Never unplug this product from the outlet when your hands are wet.
- Set the power switch to the down OFF position before you unplug the unit from the wall, plug the unit into the wall, or plug in devices.
- Be careful with the power cord. Do not jam the power cord against sharp edges. Do not use the unit if the cord appears to be damaged or if the ground prong is missing. When the unit is not plugged in, wrap the power cord around cord wraps.
- Do not use an extension cord with this unit.
- Inadequate repair can create significant hazards to users and is not covered by the warranty. Repairs should always be performed by a qualified electrician.
- Special alerts for carts:
 - To protect the carts' contents and structural integrity, make sure the doors are closed and latched before moving the cart.
 - Do not use the power cord to pull the cart.
 - Do not roll the cart over the power cord.
 - Anthro does not accept any liability for damage if the unit is misused, incorrectly operated or inadequately repaired. Under these circumstances the warranty will be void.



External Power

Charging Carts come with three power receptacles on the back of the cart. When the power switch is in the up ON position, these receptacles receive power and the indicator light is illuminated.

Doors and Locks

The doors on each cart feature a two-point keyed locking system to protect your devices. Cabinet doors have single-point locks. To open a door, lift the bottom of the handle and rotate it to the inside of the unit. Your unit shipped with 2 keys. Contact Anthro, 800.325.3841, for replacements.

For added security, each front door features hasps to hold your own padlock. When installed, your padlock restricts access to the handle so the unit can't be opened.

To protect each carts' contents and structural integrity, latch cart doors before moving the cart.



Cable Management

In the front User area, each shelf has 10 bays (for the TAB40 cart and TAB20 cabinet) with 11 dividers or 8 bays (for the TAB32 "Big Bay" cart) with 9 dividers. Starting at the far right-hand side of each shelf, route one cord through the channel at the top of the divider. The left-hand divider on each shelf will not have a cord. Make sure the cord end that goes into the device is at the front of the cart and the power end goes through the back panel and into the IT area. Leave enough slack in front so users have enough cord to easily plug into the device without straining the cord. To quickly measure an adequate length, use the height of the divider as a measuring stick.



In the IT area, poke cable clips into the holes in the pegboard divider and route cords. Plug in each power adapter, then connect each cord to an adapter. Turn the power switch to the OFF position before plugging the cart or cabinet into the wall.

Loading Devices

From the front User area of the unit, place one device in each bay with the power inlet facing front.

Laptop Storage

Store a single laptop in the front User area. Its power receptacle is in the the IT area.



Trouble Shooting Questions

Does it sync?

Yes, Anthro's carts and cabinets sync. Use either your facility's wireless network or, for a wired connection, use Anthro's USB Sync Kit (sold separately). Learn more at anthro.com/tablet.

How do I know if my computers will draw more than the allowed current?

Have a qualified electrician verify the unit's current draw. Perform this test with devices installed and batteries discharged.

The devices are all plugged in, but they won't charge. What do I do?

First, check the cart or cabinet: With the switch in the down OFF position, inspect the main power cord and plug to make sure that they're undamaged. Plug the cord into a working power outlet. Next, check the devices: Verify that each device is connected to its power adapter and that each brick is plugged into the power column. Move the switch to the up ON position to direct power to the devices. Still need some help? Call Anthro at 800-325-3841 for assistance.

Someone tried to break into the unit and damaged a door. Can it be replaced?

Yes, you can order a replacement. Call Anthro at 800-325-3841. We'll ask you for the model number of your unit and whether it's for the front, side, or back of the unit.

My power cord/plug is damaged. Is it covered under warranty?

No, it is not covered under warranty. If the plug is damaged, have a qualified electrician replace it. If you need a replacement cord, contact Anthro at 800-325-3841.

When I plug in the unit it trips the circuit breaker. What is wrong?

The carts and cabinets are designed to run on a 15 amp circuit. If you have other equipment or appliances plugged into the same circuit you may be overloading it. Have a qualified electrician check that adequate power is available in the circuit.

My unit was damaged during shipment. What should I do?

Anthro has a program established with our freight carriers to address ship damage. Please contact Anthro at 800.325.3841 and we'll work with you.

How do I find the unit's serial number?

The serial number label is located inside the IT compartment near the base.

Can I remove a bay divider?

Yes! Locate the tab at the base of the front of the divider. Place a piece of masking tape on the shelf in front of the tab to protect the shelf's finish, then carefully and gently pry up the tab using a narrow flat-head screwdriver.

STEP 1

Select the Mounting Location and Method

- When choosing the right place to install your cabinet, be sure to check the location of your power source. The power cord that comes with your cabinet is 10 ft long.
- Your cabinet can be wall-mounted to wood wall studs or drywall, or bolt it to a countertop. If you're installing to wood wall studs, go to Step 2. If you're installing into drywall, go to Step 3. If you're bolting to a countertop, go to Step 4. The cabinet also comes with cushioned feet; use them if you're placing your cabinet on a flat surface. See Step 5 for installation instructions.

STEP 2

Wall-mount to Wood Wall Studs

This is a two-person step.

- Determine the installation point for your cabinet. Using a stud finder, locate the studs. While one person holds the cabinet frame up to the wall at the desired height, the other marks the height of the top of the cabinet. Measure down 1-1/2" along the studs to determine the position of the screws and mark where the screws will go. Use a level to make sure the marks are level.
- Using a 1/8" drill bit, drill one hole in a stud about 1-1/2" deep. How do you make sure that hole is 1-1/2" deep? Measure that length on your drill bit and mark it with a piece of masking tape. Stop drilling when you reach the masking tape. Repeat for the second screw.
- Using a Phillips driver (or a power driver with a Phillips bit), attach the first 1-5/8" long screw at that mounting point, but don't tighten all the way to the wall. Stop tightening when the screw head is about 1/4" away from wall.
- Lift the cabinet onto the wall. Mark the screw position of the lower screws. Remove the cabinet, drill the lower holes, and install the lower screws. Lift the cabinet into place and tighten all four screws.

Wall Stud Profile

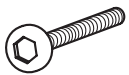
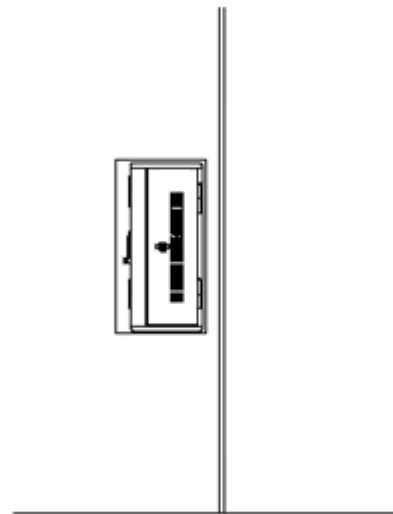
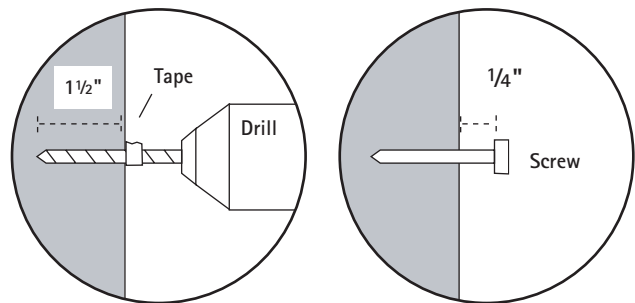

1-5/8" Screw
325-5086-00

Go to Step 6.

STEP 3

Wall-mount to Drywall

- Determine the installation point for your cabinet. While one person holds the cabinet frame up to the wall at the desired height, the other marks the height of the top of the cabinet. Measure down 1-1/2" to determine the position of the screws and mark where the screws will go. Use a level to make sure the marks are level.
- Drill 1/2" diameter hole at the mounting point.
- Insert a TOGGLER into one hole, metal end first.
- Pull the plastic ring end so the metal channel rests flush behind the wall. With your other hand, slide the plastic cap along the straps until the flange of the cap is flush with the wall.
- Place your thumb between the plastic straps. Push side to side, snapping off the straps at the wall.
- Insert a 1-5/8" long screw into the TOGGLER, but don't tighten all the way. Leave the bolt head about 1/4" from the plastic cap.
- Repeat for the second TOGGLER.
- Lift the cabinet onto the wall. Mark the screw position of the lower screws. Remove the cabinet and install the lower TOGGLERS. Lift the cabinet into place and tighten all four screws.

Go to Step 6.

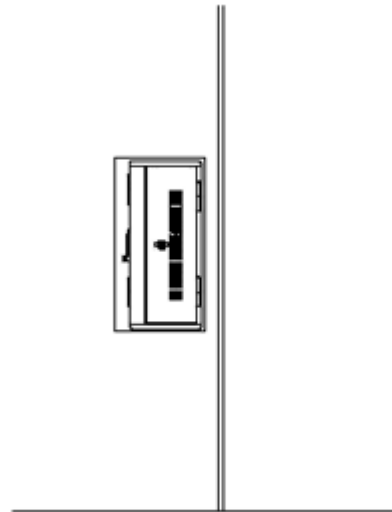
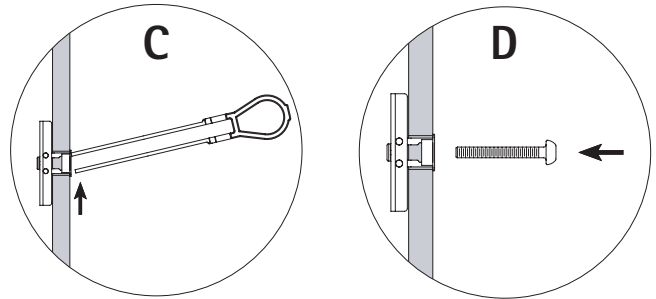
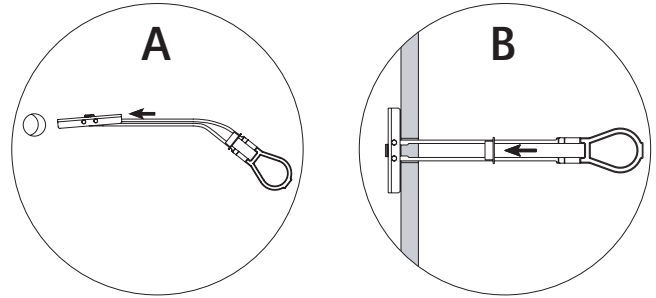

STEP 4

Bolt-through Installation to Countertop

- Pre-drill a 1/4" dia hole in your countertop or shelf.
- Using a box knife, slice through the membrane covering the pre-drilled holes on the bottom of the cabinet.
- Slide the 3.5" bolt through the washer, through the bottom of the cabinet, through the countertop, and capture with the 325-5259-00 nut.

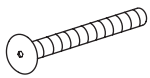

3.5" Bolt
325-5657-00



5/8" Washer
325-5379-00



Nylock Nuts
325-5259-00

Go to Step 6.

STEP 5

Install Feet

- Stick a 3/4" wood screw through each rubber bumper (581-5063-00).
- Locate the four pre-drilled holes on the bottom of the cabinet, one in each corner. Using the Anthro driver, attach each foot to the cabinet.

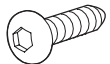

3/4" (#10-9) Wood Screw
325-5575-00

STEP 6

Install the Bay Labels and Route Cables

- Your cabinet comes with labels for numbering the bays in your cabinet. Line up each label with the front face of the bay shelf, peel of the backer, and affix the label.
- In the front User area, poke cable clips into the holes along the bay dividers. Route cables so the power inlet is positioned next to the device. Run the cable through the clips to the tray that runs along the back panel. Gather each row's cables into a cable tie at the end of the tray.
- In the side IT area, poke cable clips into the holes in the pegboard divider and route cords. Plug in each cord. Turn the power switch to the OFF position before plugging the cabinet into the wall.

CONGRATULATIONS! YOUR CABINET ASSEMBLY IS COMPLETE!

Anthro Corporation Limited Warranty

What Does This Warranty Cover?

This warranty covers any defects in material or workmanship in Anthro Charging Carts and Cabinets for Touch Technology.

Who is Covered By This Warranty?

This warranty extends to the original consumer of the product only.

How Long Does This Warranty Last?

The warranty lasts for two years from date of purchase for the electrical components (excluding the data cables, power cord and plug) and lifetime for the cabinet.

What Will Anthro Do?

Anthro will send replacement parts only. Labor is not included.

What Is Not Covered By This Warranty?

This warranty does not cover the power cord. This warranty does not cover product that has been damaged by accident, unreasonable use, neglect, inadequate repair, tampering or other causes not arising from defects in material or workmanship FOR AS LONG AS THE WARRANTY PERIODS LISTED ABOVE. Labor costs are not included. This includes but is not limited to the implied warranties or merchantability and fitness. Some states do not allow limitations on how long an implied warranty lasts, so this limitation may not apply to you.

ANTHRO'S RESPONSIBILITY IS LIMITED TO THE ACTIONS LISTED UNDER "What will Anthro Do?" AS LISTED ABOVE AND NOTHING ELSE.

This warranty does not cover, and Anthro will not be responsible for, any damages you may have due to loss of use of the product, or any other costs or expenses incurred by you or anyone else who uses the product, whether due to defects, breach of contract, negligence, strict liability or otherwise. ANTHRO IS NOT LIABLE FOR ANY INDIRECT, SPECIAL, INCIDENTAL, OR CONSEQUENTIAL DAMAGES RELATED TO THE PRODUCT OR THIS WARRANTY. Some states do not allow the exclusion or limitations or consequential or incidental damages, so these limitations or exclusions may not apply to you.

How Do I Get Service?

Call Anthro at 1-800-325-3841.

How Does State Law Apply To This Warranty?

This warranty gives you specific legal rights and you may also have other rights that vary from state to state. This warranty is governed by the laws of Oregon, excluding its conflict of laws principles, unless your state requires that its law be used.



Touchboards

205 Westwood Ave, Long Branch, NJ 07740
Phone: 866-94 BOARDS (26273) / (732)-222-1511
Fax: (732)-222-7088 | E-mail: sales@touchboards.com



300-5549-00

Please return the enclosed
Registration Card to receive
our product updates, new
catalogs, and sale flyers.

Rev B | July, 2012

Notices:

Technology Furniture™ and Anthro / Where technology meets comfort™ are registered trademarks of Anthro Corporation.
Anthro reserves the right to modify the design and specifications without prior notice.