



Touchboards

205 Westwood Ave, Long Branch, NJ 07740

Phone: 866-94 BOARDS (26273) / (732)-222-1511

Fax: (732)-222-7088 | E-mail: sales@touchboards.com

SAMSUNG

TECHWIN

SVP-5500 Video Presenter User's Guide



Features

Various image control

Digital features on your Video Presenter provides useful and various image controls including:

- Negative/positive image conversion
- Brightness and R/B color control
- Flicker reduction
- Image rotation up to 180°
- Image Freeze (*SVP-5500DX only*)

Input source selection

You can quickly switch between your computer presentation and your document presentation with the INT/EXT button on the control panel or on the remote control.

Flexible and rotatable head

The camera head and arm of your Video Presenter can be rotated up to 180° to enable you to capture all images surround you.

Connection with PC

You can connect to PC with USB or RS-232C cable and store the projected image into the computer. You can also edit the image on the computer with the supplied SVP-5500 program. USB connection and SVP-5500 program is available for *SVP-5500DX only*.

Custom user settings

To avoid any interruption of presentation to reset the video presenter, you can preset up to 8 customized settings in the memory and recall it during the presentation simply.

Remote control

You operate your presenter through a hand-held remote control, with buttons for adjusting the projected image and accessing all the presenter's features.

Optional accessories

To enhance your use of the presenter, LCD monitor and sub camera are available. With the LCD monitor, you can view the image without connecting to a monitor or TV. The sub camera gives you the great ability to shoot precise angles and close-up images even from a microscope.



Table of Contents

Safety Precautions	2
Unpacking	3
Your video presenter	4
Front view	4
Rear view	5
Controls	6
on the Control panel	6
on the Remote control	7
Setting up	8
Connecting to output device	10
TV or Monitor	10
Desktop computer	11
USB connection	11
RS-232C connection	11
Connecting external input	10
AV device	12
Computer	13
Microphone	13
Using the presenter	14
To see the image received from external device ..	14
To project an object on the video presenter	16
Adjusting your image	19
Adjusting image size	19
Adjusting brightness	19
Adjusting image color	20
Positive and negative switching	20
Rotating image	20
Saving image in memory	21
Screen divide and image shift	21
Saving custom user settings	22
Reducing flicker	22
Optional accessories	23
LCD monitor	23
Sub camera	23
Storage	24
Troubleshooting	26
Replacing fuse	27
Specification	28



Safety precautions

Follow these safety instructions when setting up and using your Video Presenter:

1. Do not place the presenter on an unstable cart, stand, or table.
2. Do not use the presenter near water or sources of heat.
3. Use the type of power source indicated on the presenter. If you are not sure of the power available, consult your dealer or power company.
4. Place the presenter near a wall outlet where the plug can be easily unplugged.
5. Take the following precautions for the plug. Failure to comply with these precautions could result in sparks or fire: Do not insert the plug into an outlet with dust present. Insert the plug firmly into the outlet.
6. Do not overload wall outlets, extension cords, or integral convenience receptacles. This can cause fire or electric shock.
7. Do not place the presenter where the cord can be walked on. It may result in fraying or damage to the plug.
8. Unplug the presenter from the wall outlet before cleaning. Use a damp cloth for cleaning. Do not use liquid or aerosol cleaners.
9. Do not block the slots and openings in the presenter case. They provide ventilation and prevent the presenter from overheating. Do not put the presenter on a sofa, rug, or other soft surface or in a built-in installation, unless proper ventilation is provided.
10. Never push objects of any kind through cabinet slots. Never spill liquid of any kind into the presenter.
11. Except as specifically explained in this User's Guide, do not attempt to service this product yourself. Refer all servicing to qualified service personnel. Opening or removing covers may expose you to dangerous voltages and other hazards.
12. Unplug the presenter during lightning storms or when it will not be used for extended periods.
13. Do not place the presenter and remote control on top of heat-producing equipment or in a heated place, such as a car.
14. Unplug the presenter from the wall outlet and refer servicing to qualified service personnel under the following conditions:
 - When the power cord or plug is damaged or frayed.
 - If liquid has been spilled into the presenter, or it has been exposed to rain or water.
 - If it does not operate normally when you follow the operating instructions, or if it exhibits a distinct change in performance, indicating a need for service.
 - If it has been dropped or the cabinet has been damaged.

FCC Compliance Statement

This equipment has been tested and found to comply with the limits for a class A digital device, pursuant to part 15 of the FCC Rules. These limits are designed to provide reasonable protection against harmful interference when the equipment is operated in a commercial environment. This equipment generates, uses, and can radiate radio frequency energy and, if not installed and used in accordance with the instruction manual, may cause harmful interference to radio communications. Operation of this equipment in a residential area is likely to cause harmful interference in which case the user will be required to correct the interference at his own expense.

Unpacking

When you unpack your Video Presenter, make sure that you have all these components.

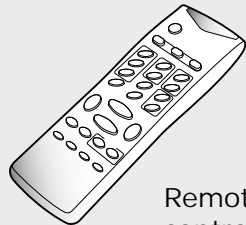

Remote control

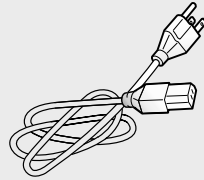

Power cable^{*1}

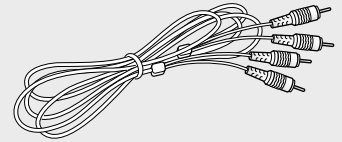

Audio/Video cables

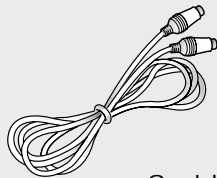

S-video cable

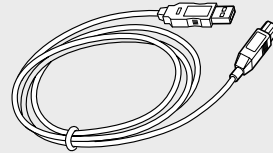

USB cable^{*2}



This User's Guide

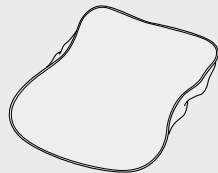

Dust cover

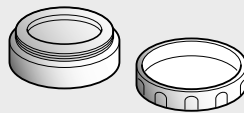

Adapter lens and lens cap

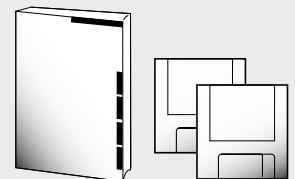

Diskettes containing SVP-5500 program and USB driver, and its User's Guide^{*2}

- *1 The shape of power cable may differ, depending on your country.
- *2 Available for SVP-5500DX only.

Optional accessories

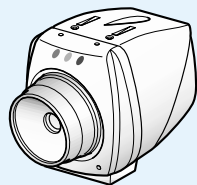

Sub camera

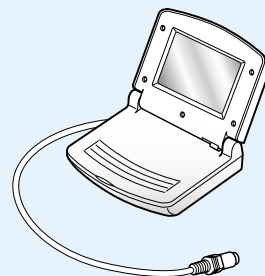

LCD monitor

Your video presenter

Front view

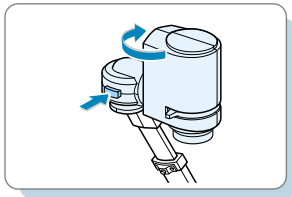

Use the button to rotate the camera head.

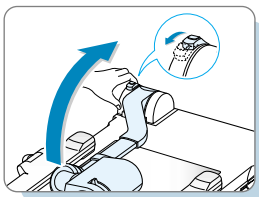

Use the switch to raise or fold the main pole.

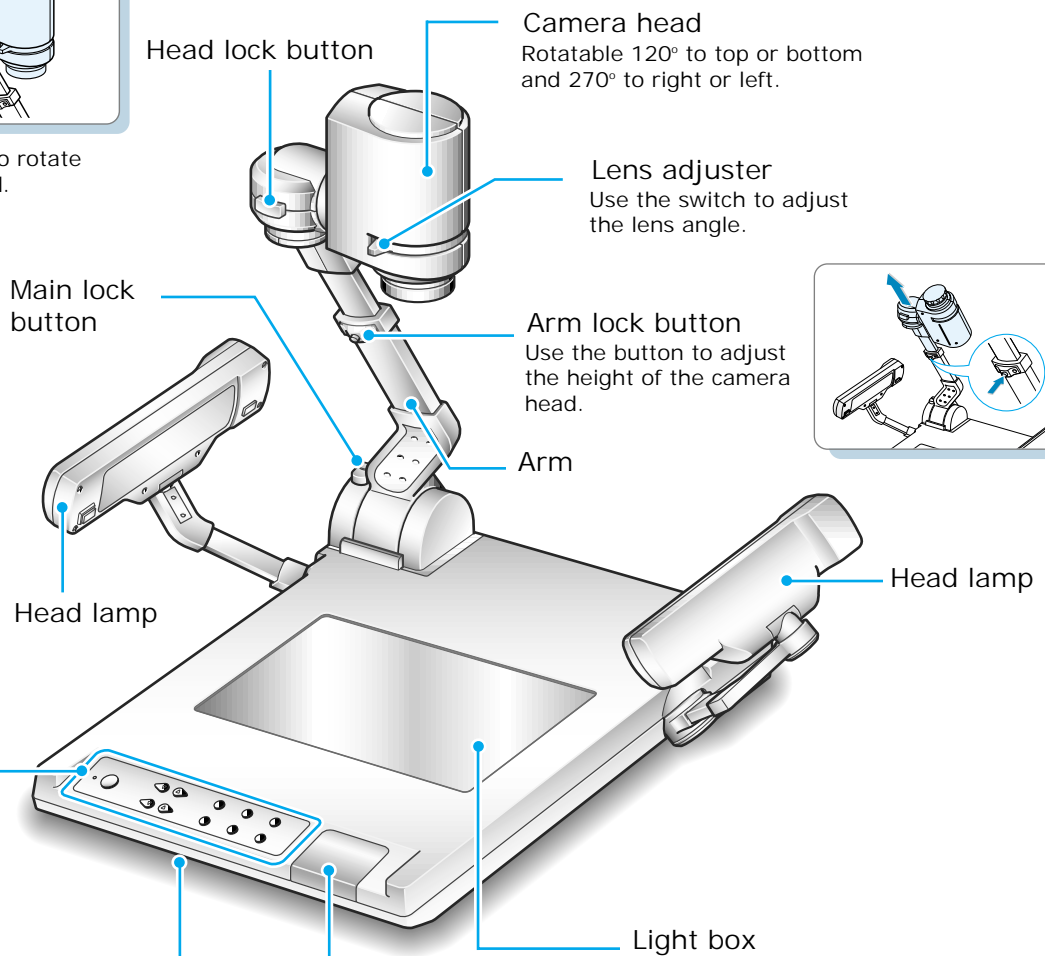
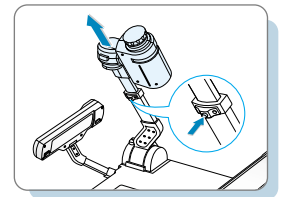

Camera head
Rotatable 120° to top or bottom and 270° to right or left.

Lens adjuster
Use the switch to adjust the lens angle.

Arm lock button
Use the button to adjust the height of the camera head.

Arm

Head lock button

Main lock button

Head lamp

Head lamp

Control Panel
See page 6.

Handle

Light box

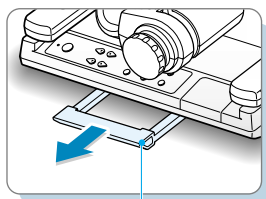

Handle is located in the bottom. Use it when you move this unit.

IR sensor
Receives the signals from the remote control.

Rear view

Power connector
Connects to AC power outlet
(100-240V AC, 50/60Hz, 2A).

USB connector
(SVP-5500DX only)

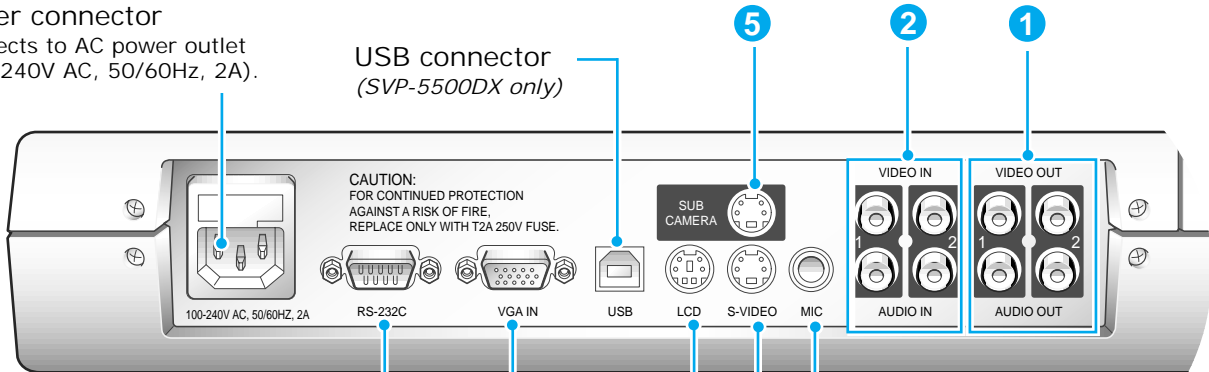

RS-232C jack
Used to connect to PC
through a serial port.

Connects optional microphone.

S-VIDEO jack
Sends video signals from your Video
Presenter to a TV equipped with S-
video input terminal.

1 VIDEO OUT 1, 2 jacks
Sends video signal from your Video
Presenter to a TV or monitor. The
signal from these two jacks are
equivalent.

AUDIO OUT 1, 2 jacks
Sends audio signal from your Video
Presenter to a TV or monitor. The
signals from these two jacks are
equivalent.

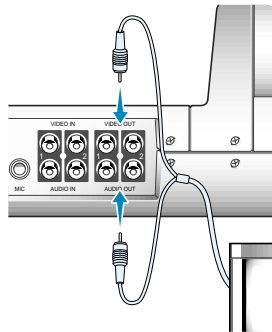

3 VGA IN jack
(SVP-5500DX only)
Connects computer
VGA port using the
monitor cable

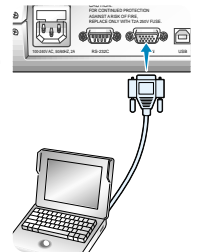

2 VIDEO IN 1, 2 jacks
Receives video signal from external
AV device (such as VCR or
camcorder). The signal from these
two jacks are equivalent.
To see the signal from this jack,
press INT/EXT button on the remote
control or the control panel of this
unit.

AUDIO IN 1, 2 jacks
Receives audio signal from external
AV device (such as VCR or
camcorder). The signals from these
two jacks are equivalent.

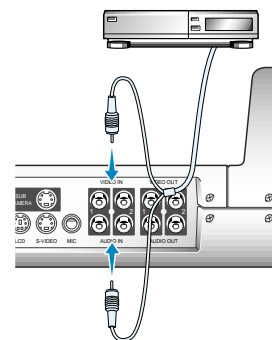

4 LCD jack
Connects optional
LCD monitor.

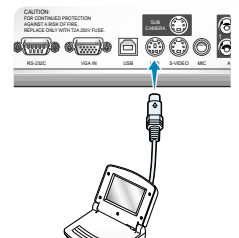

5 SUB CAMERA jack
Connects optional
sub camera.

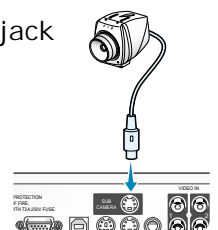

Controls

You can find the same function buttons both on the control panel of your SVP-5500 and the remote control. You can use any of them to perform the function.

on the Control panel

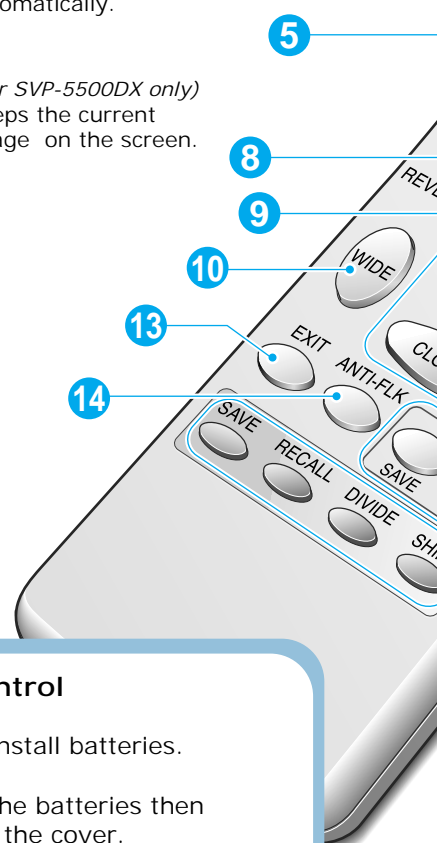
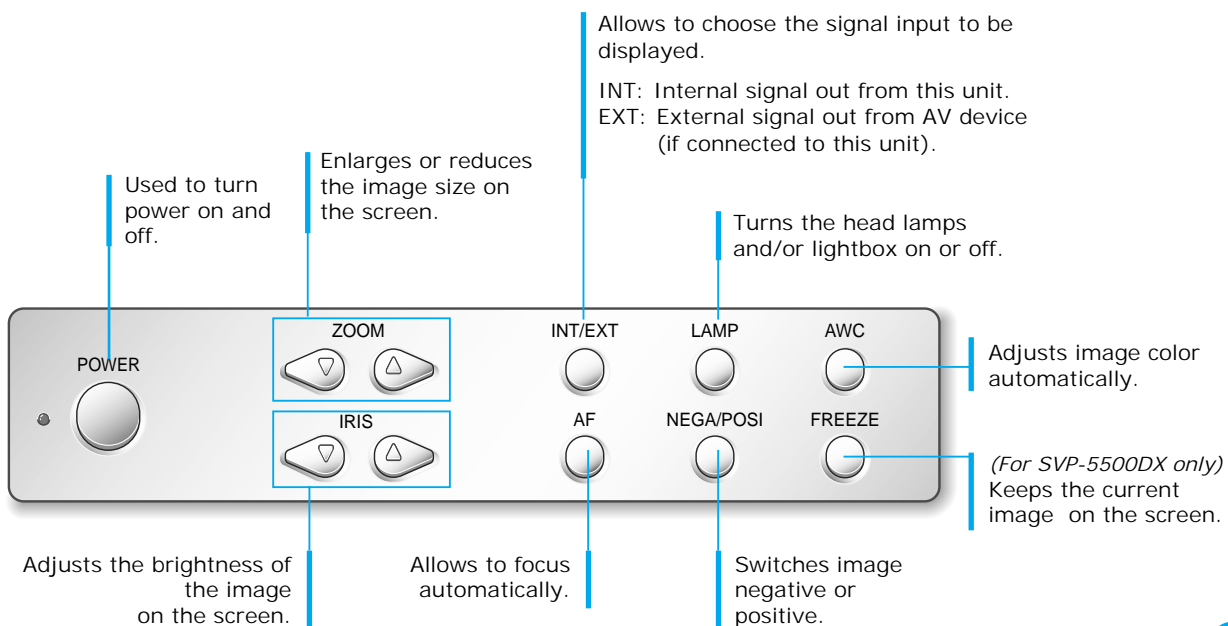

Installing Batteries in the Remote Control

Before using the remote control at first time, install batteries.

1. Remove the cover on the back of the remote control.
2. Insert the batteries then replace the cover.

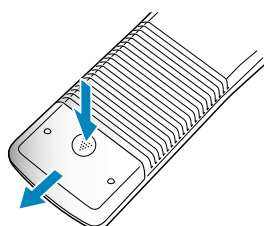

Battery type:
AAA type 1.5V

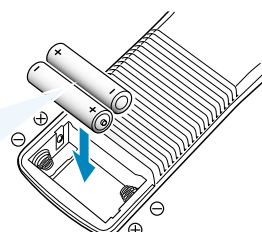

on the Remote control

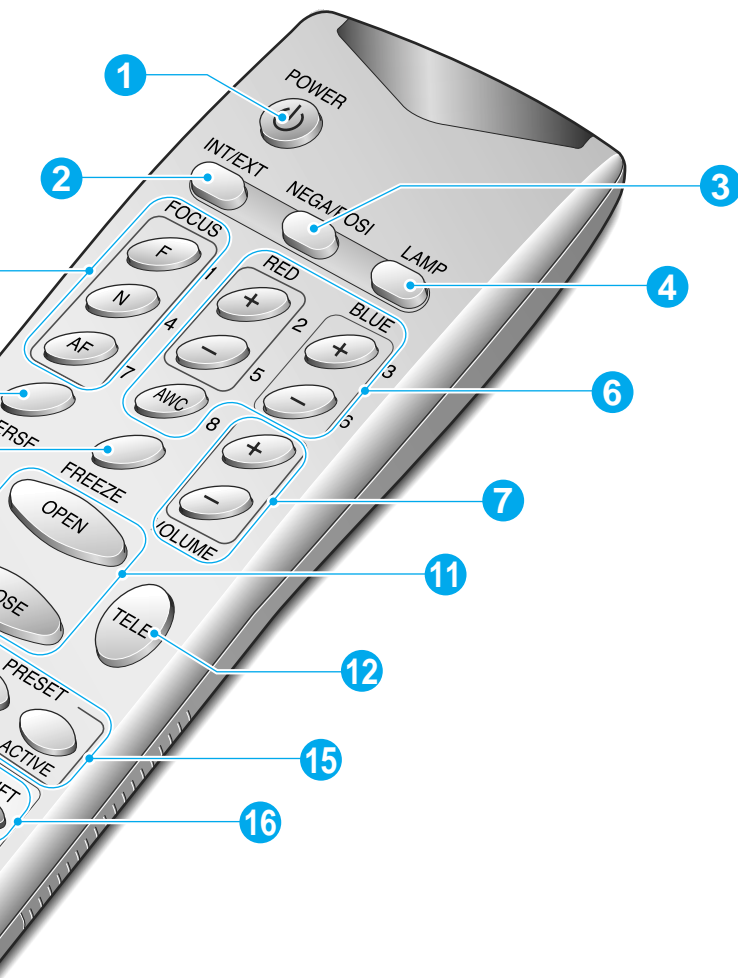

- 1 POWER**
Turns power on and off.

- 2 INT/EXT**
Allows to choose the signal input to be displayed.

- 3 NEGA/OSI**
Switches image negative or positive.

- 4 LAMP**
Turns the head lamps and/or lightbox on or off.

- 5 FOCUS**
Allows to focus an object.
F: Used to focus an object which is in the far distance.
N: Used to focus an object being close.
AF: Used to focus automatically.

- 6 RED/BLUE/AWC**
Adjusts the image color.
R +/- : Adjusts the red color.
B +/- : Adjusts the blue color.
AWC : Adjusts color automatically.

- 7 VOLUME**
Adjusts the audio volume.

- 8 REVERSE**
Puts the image on the screen into reverse. It rotates the image by 180°.

- 9 FREEZE** (for SVP-5500DX only)
Keeps the current image on the screen.

- 10 WIDE/TELE**
- 12**
 - Enlarges the image size.
 - Reduces the image size.

- 11 OPEN/CLOSE**
 - Opens iris to increase the brightness.
 - Closes iris to decrease the brightness.

- 13 EXIT**
Stops current function and return to the normal mode.

- 14 ANTI-FLK**
Reduces the flicker on the screen.

- 15 PRESET**
 - Saves the customized user setting values.
 - Activates the preset user settings.

- 16 SAVE/RECALL** (for SVP-5500DX only)
 - Saves the projected image into the memory of this unit.
 - Recalls the image from the memory.

DIVIDE (for SVP-5500DX only)
Divides the screen to see both of the current image and the image recalled from the memory simultaneously on one screen.

SHIFT (for SVP-5500DX only)
Shifts the recalled image shown in the divided screen from the left to right to see the hidden portion of the image.



Note SVP-5500ST users can find FREEZE, SAVE, RECALL, DIVIDE, and SHIFT buttons, but the buttons do not perform corresponding functions. The buttons are activated in SVP-5500DX only.

Setting up

1

While you pull the main lock button toward the front of the presenter, lift the arm.

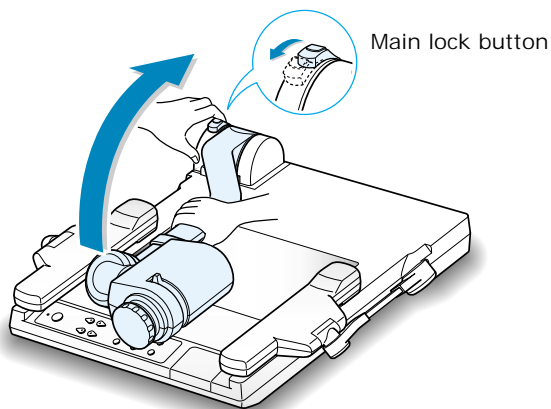

2

Raise the head lamps at both sides.

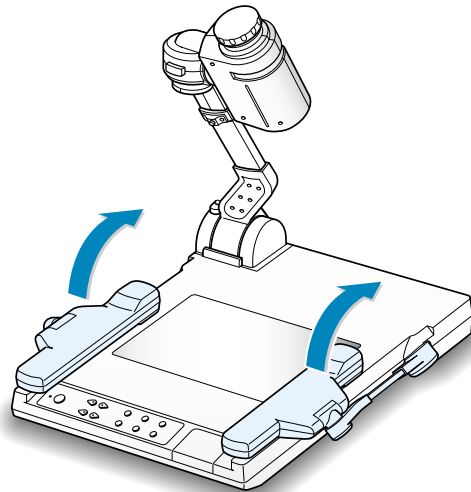

5

Holding the head, adjust the angle of the head.

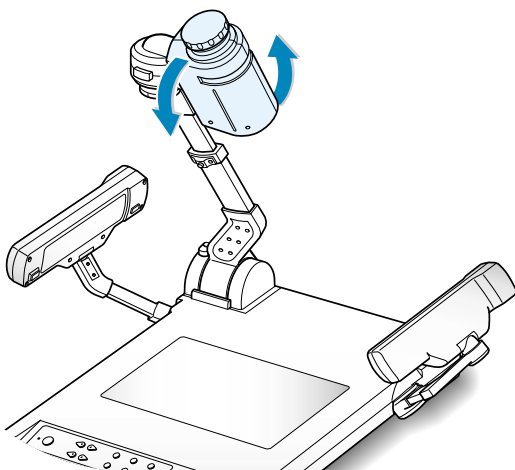

6

Remove the lens cap.

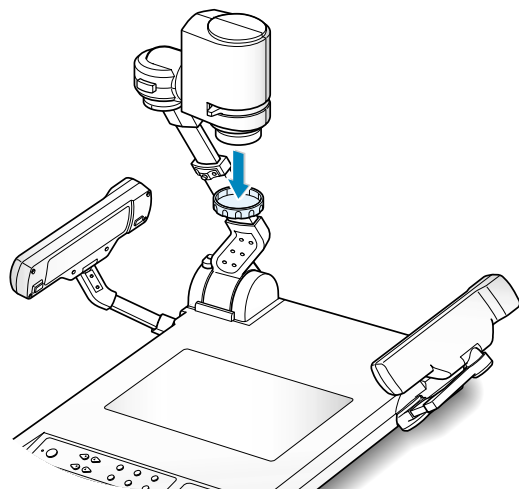

- 3** Adjust the angle of the lamps properly.

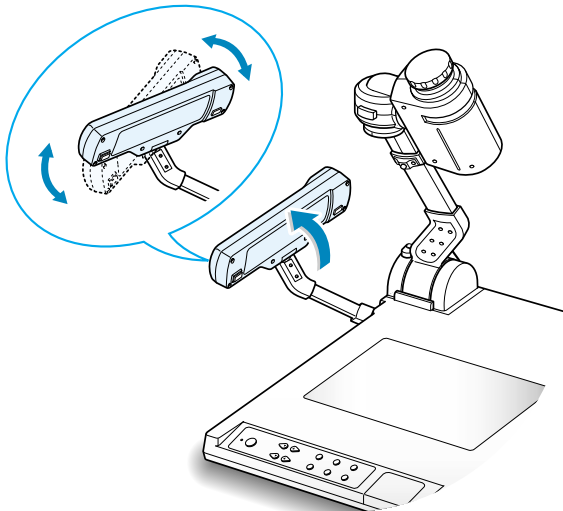

- 4** While you hold the arm lock button, pull up the head to adjust the height.

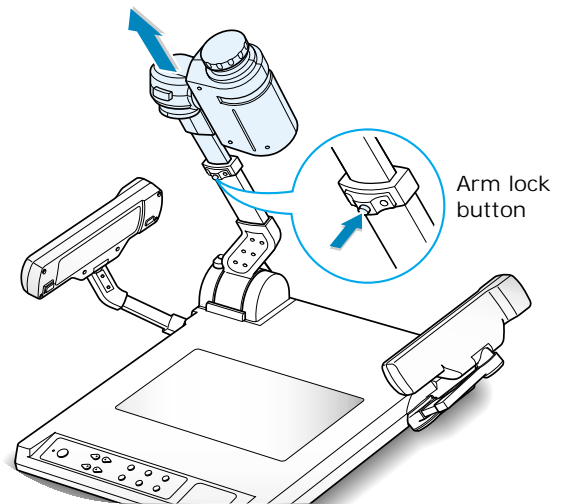

- 7** Plug the power cord in.

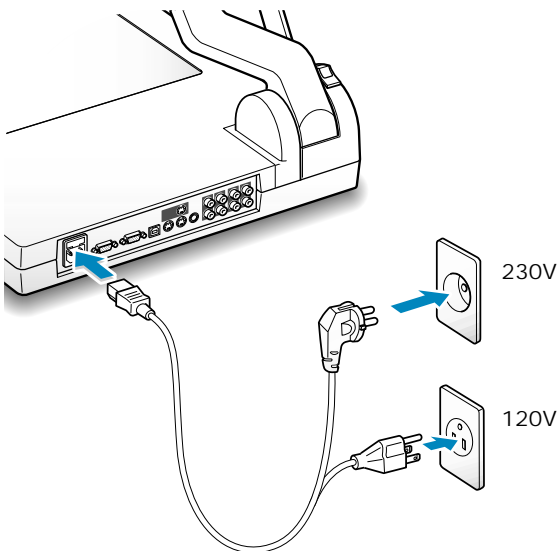

- 8** Connect the output and another input device properly according to your needs.
(See pages 10 through 13.)

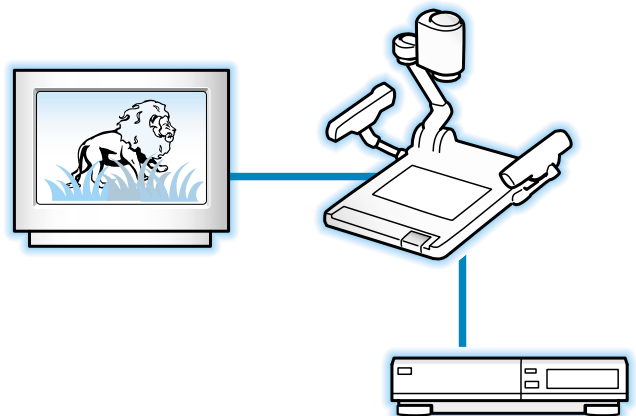

Connecting to output device

TV or Monitor

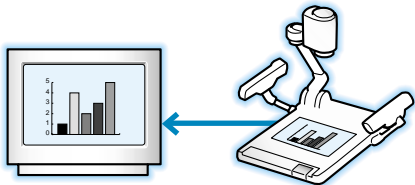

Connect a TV or monitor to this presenter to display the projected image using the AV cables or S-video cable.

If you use an optional microphone or if your presentation includes sound effects which is received from AUDIO IN jack, you need to connect the audio cable to AUDIO OUT jack.

Connection

Connect the yellow plug to the **VIDEO OUT** and white plug to **AUDIO OUT** jack.

You may use 1 or 2 jack.
The signal from these jacks are equivalent.

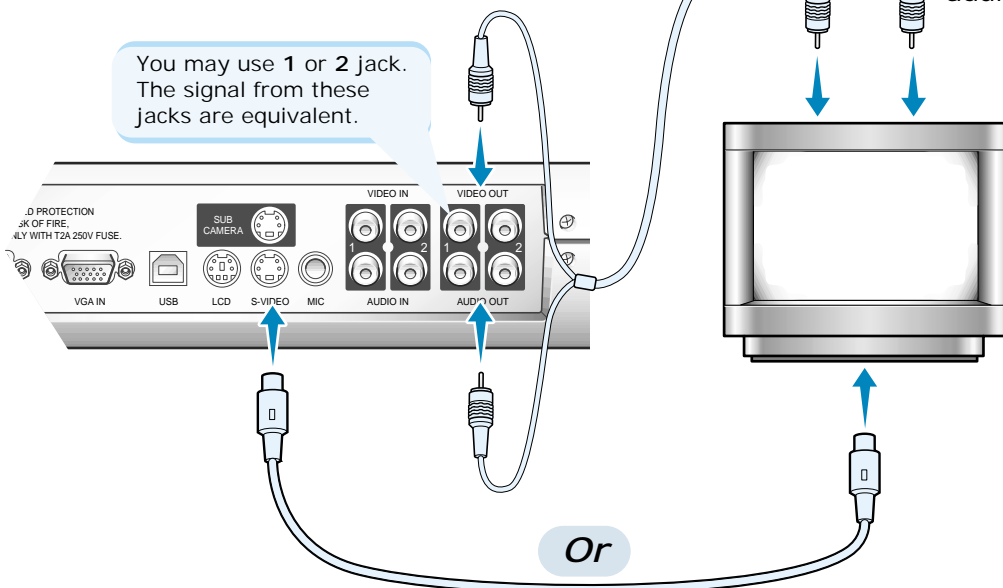

Connect the yellow plug to the video input and white plug to the audio input port.

If you have a TV or monitor equipped with S-video terminal, you can connect to S-video jack.



If you connect to S-video terminal, you may obtain more clear image, but the signal from the external AV source (if connected) is not available on this terminal.

Desktop computer

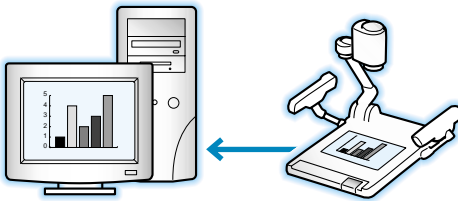

For SVP-5500DX, connect a desktop PC using USB cable and install the supplied SVP-5500 program. You can see the projected image on the PC monitor and control the image as a graphic file using the program.

RS-232C connection is available for advanced user. If you connect a PC with RS-232C cable, you should set up your PC and make your own program to control the projected image on PC. Ask your dealer for further details.

USB connection (SVP-5500DX only)

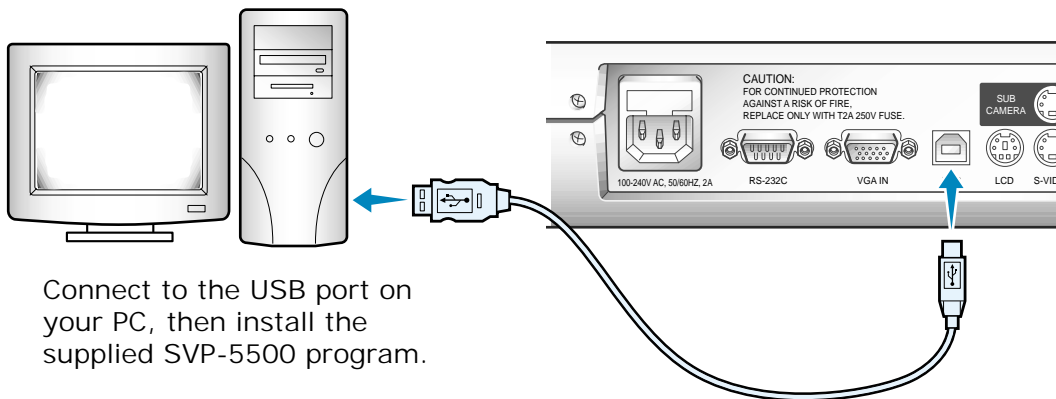

Connect to the USB port on your PC, then install the supplied SVP-5500 program.

RS-232C connection

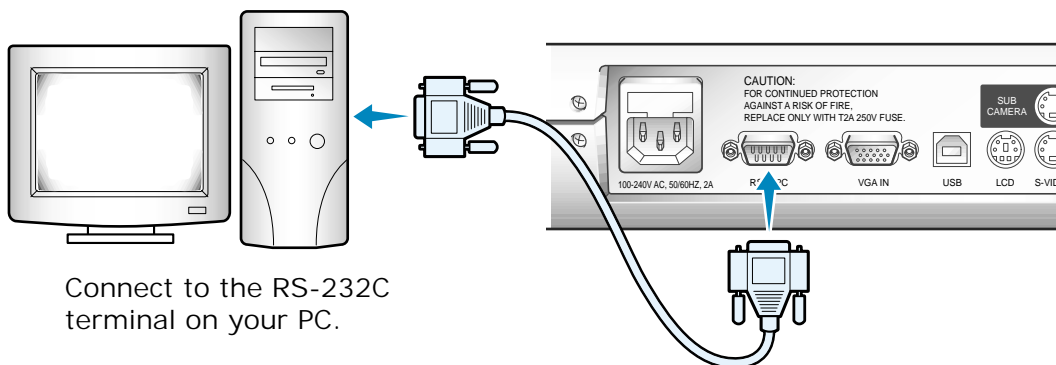

Connect to the RS-232C terminal on your PC.



RS-232C cable is not provided with the presenter. You can obtain one from your computer dealer.

Connecting external input

AV device

If you want to use image from external video source such as as VCR, camcorder, laser disk player, DVD player, or any other compatible AV device, connect the device to your presenter. With the **INT/EXT** button on the presenter, you can switch the input source during presentation from this external source and the internal signal from the presenter.

If you wish to use audio, connect the audio cable between the AV device and your presenter.



Connection

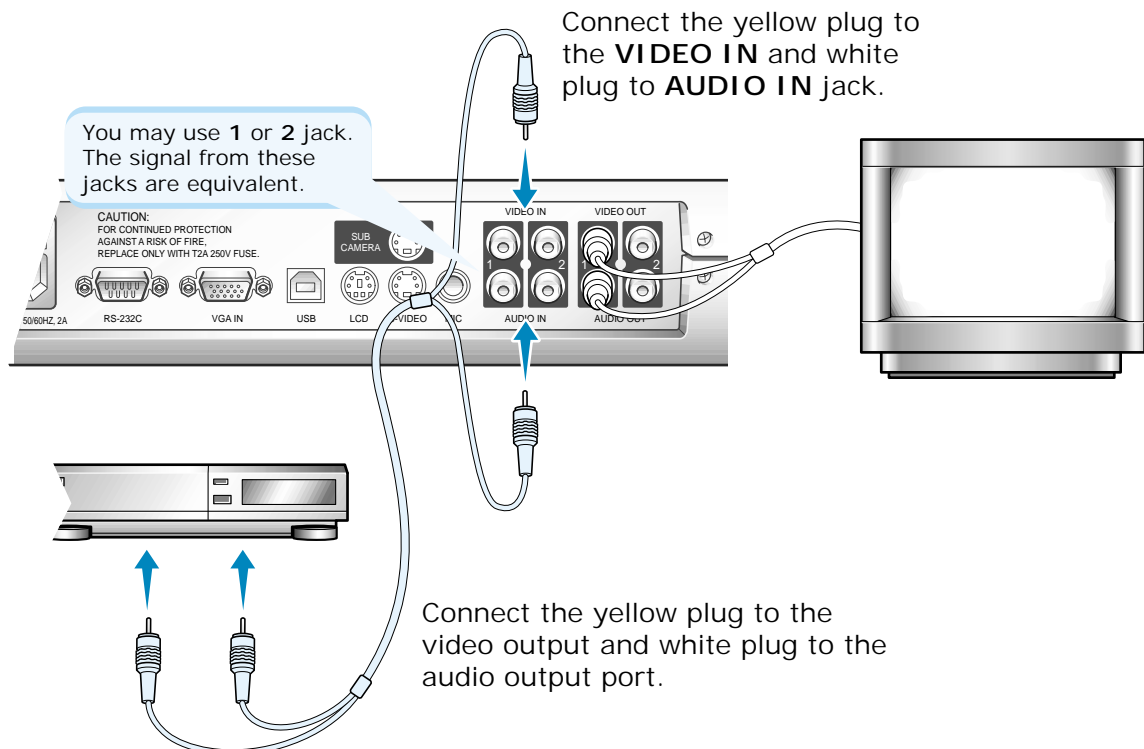

Computer

If you connect computer through VGA IN port, you can receive video signal from the computer.

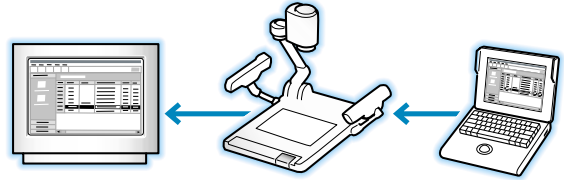

Connection (SVP-5500DX only)

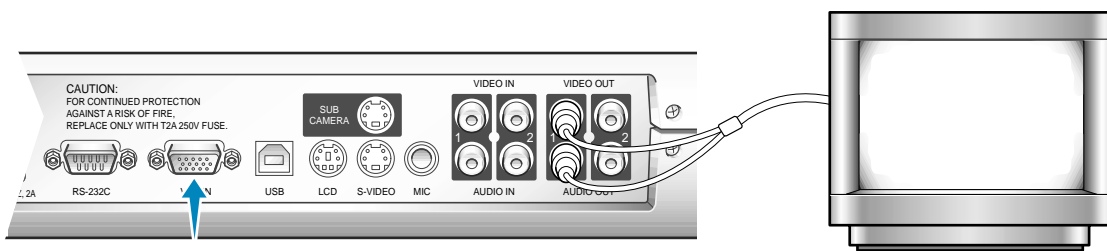

Connect to VGA IN terminal using the VGA cable from the computer. VGA IN terminal is available for SVP-5500DX only.

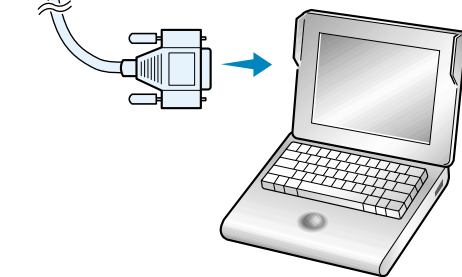

Connect to VGA port on the computer equipped with XGA, SVGA, or VGA graphic card.

Microphone

To enhance the presentation with the presenter's voice guidance, use a microphone. Microphone is not supplied with this presenter.

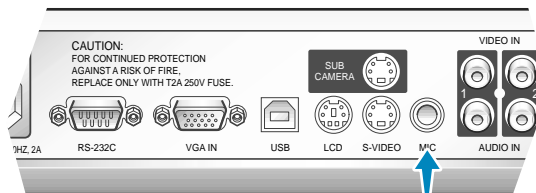

Use a microphone equipped with 6.3.

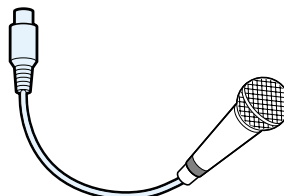

Using the presenter

To see the image received from external device

- 1 Set up your video presenter properly.
(see page 8 and 9.)

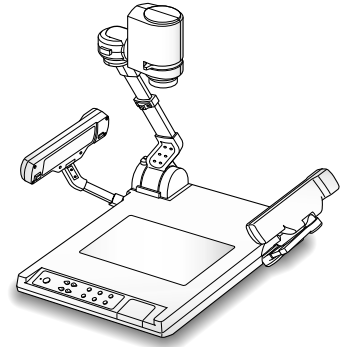

- 2 Connect the input device from which you want to receive the image and the output device on which you want to see the image.
(see pages 10 through 13.)

- 3 Turn the power of the input and output device, and the video presenter on.

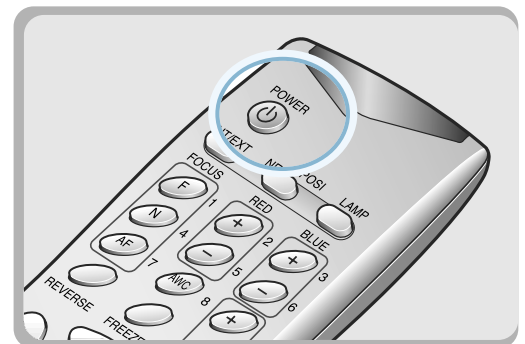
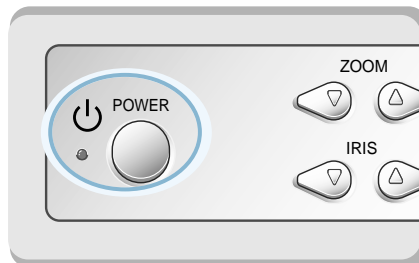

When the video presenter is powered on, the head lamps turn on. To turn it off, press LAMP button of the presenter.

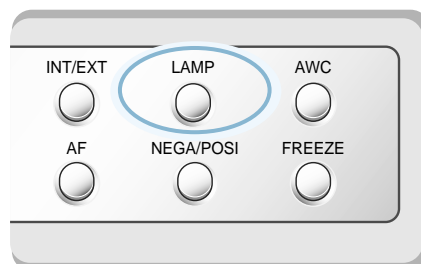

Effective range of the remote control

When using the remote control, always aim it directly at the remote control receive window of your video presenter. Refer to the figure at the right side for acceptable range.

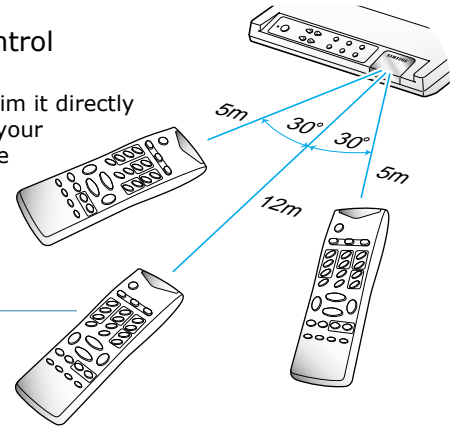

4 Choose the video source with the INT/EXT button of the presenter.

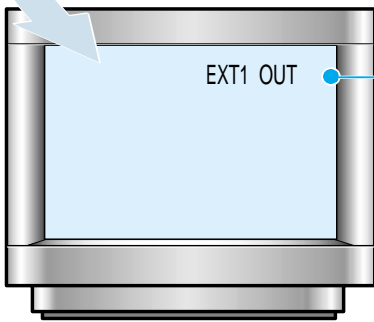
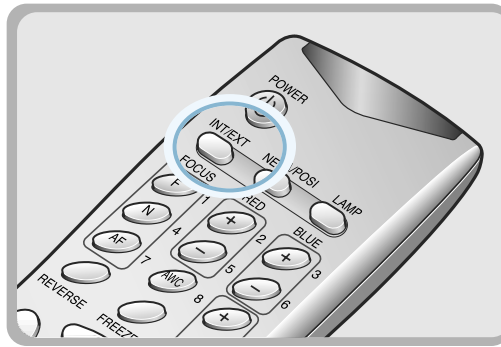
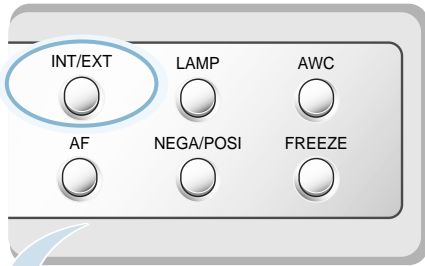

- Each time you press the button, the display shows EXT1 OUT, EXT2 OUT, AUX OUT, VGA OUT, INT OUT.
- **EXT1 OUT, EXT2 OUT**
Choose this mode to see the image of the AV device such as camcorder, video, laser disk player, DVD player.
- **AUX OUT**
Choose this mode to see the image on the optional sub camera.
- **VGA OUT** (available for SVP-5500DX only)
Choose this mode to see the image on the computer connected to the VGA IN port.
- **INT OUT**
Choose this mode to see the image through the lens of the video presenter.



If NO EXT SYNC is displayed, check if the external input device is connected properly.

5 Open the image on the AV device or computer. Now you see the image through the TV or monitor.

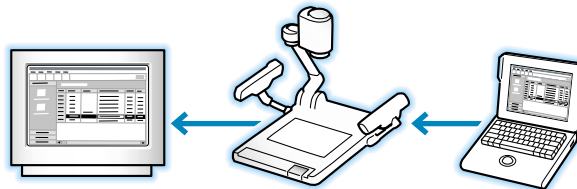

6 If necessary, you can adjust the audio volume using the volume buttons on the remote control.

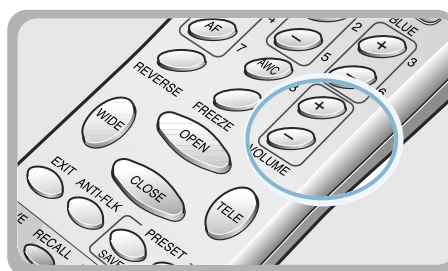

Using the presenter *Continued*

To project an object on the video presenter

- 1 Set up your video presenter properly. (see page 8 and 9.)

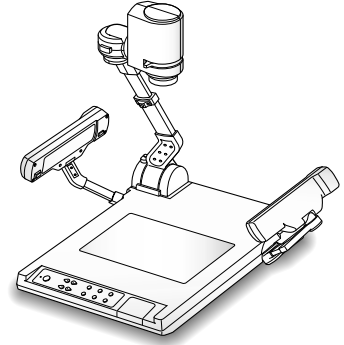

- 2 Connect to a TV or monitor to display the image. (see page 10.)

- 3 Turn the power of the output device and the video presenter on.

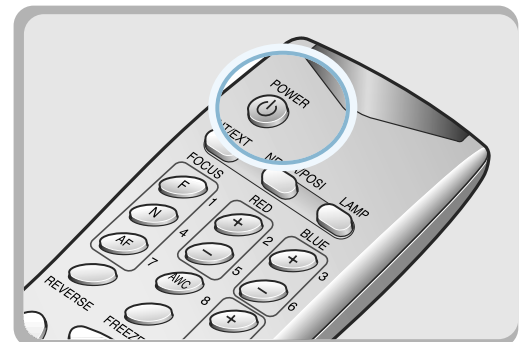
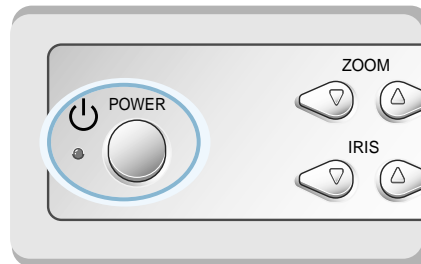

- 4 Place the object on the lightbox, and adjust the head to face the object.

If you want to rotate the image displayed, use this switch to adjust the lens position.

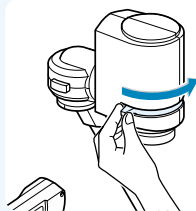

If there is no image on the TV or monitor, check if the cable is properly connected, and press the INT/EXT button of the presenter to select the input mode to INT OUT.

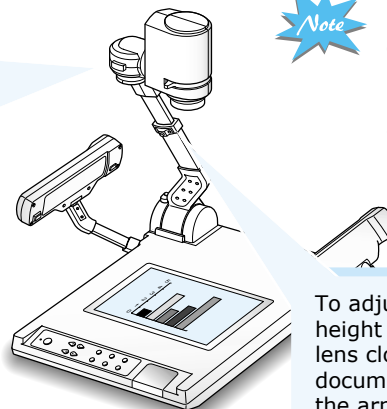

To adjust the height to put the lens closer to the document, lower the arm while you hold down the arm lock button.

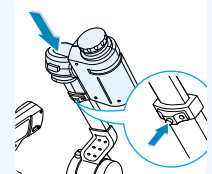

5

Select a proper lighting source with the LAMP button of the presenter. Each time you press the button, head lamps on, lightbox on, then all lighting off.

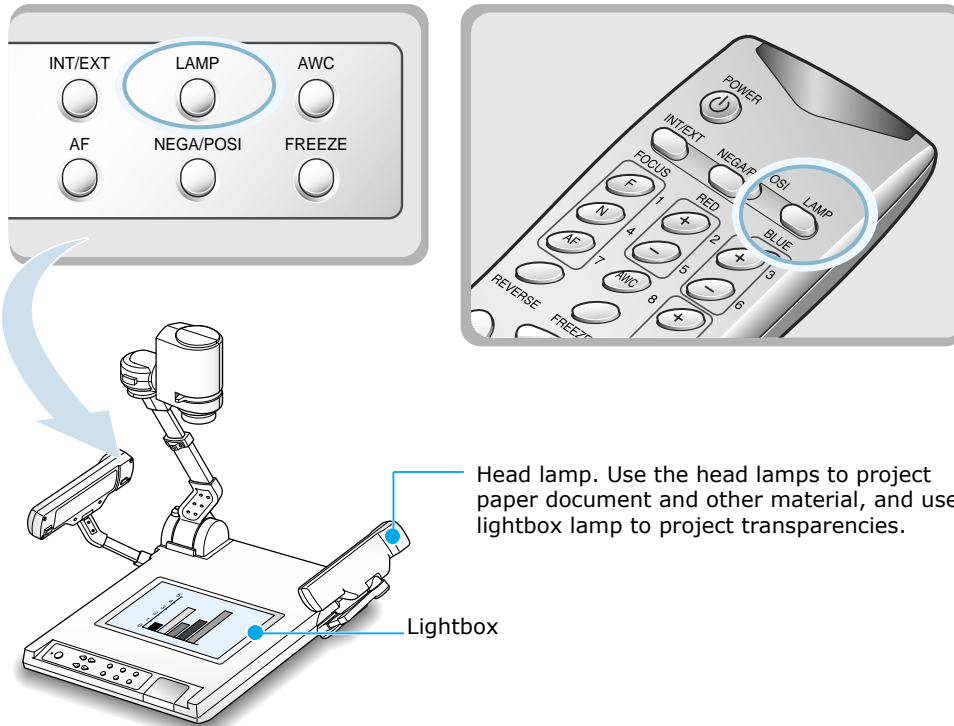

Head lamp. Use the head lamps to project paper document and other material, and use lightbox lamp to project transparencies.

6

Remove or attach the adapter lens according to the object projected.

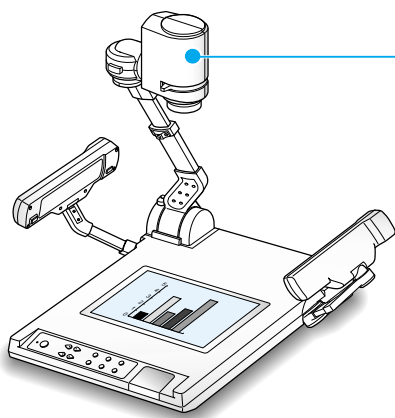

Rotate the lens to remove or attach it.

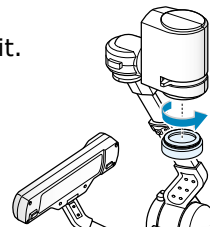

- Adapter lens is required when you project an object placed on the lightbox. (Focusable distance : 24-32 cm)
- Adapter lens must be removed to focus on the object located over 80 cm away.
- You cannot focus on object properly when the distance between the object and the camera is out of range stated above.

7 Focus on the object.

- In most situations, it is better to use the automatic focus feature. Use **AF** button for automatic focusing.
- In some conditions, however, automatic focusing may be inadequate. Then you must focus manually. Press **FOCUS F (FAR)** button or **FOCUS N (NEAR)** button on the remote control to focus on object being far away or on object being close to the camera lens.

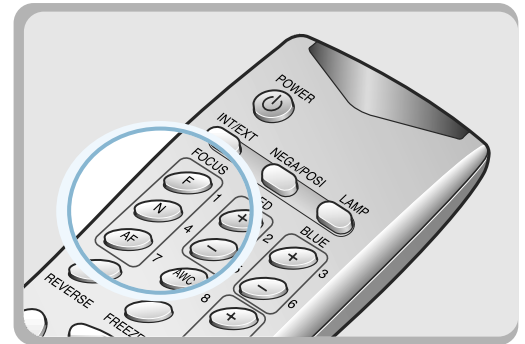
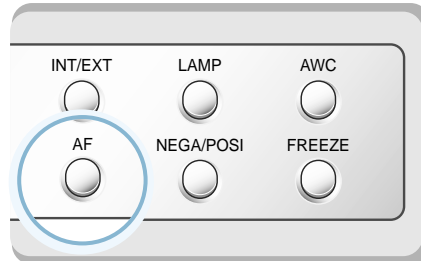

Auto focusing is not work properly when you try to focus on objects in conditions below.

In this case, adjust the focusing manually.

- Object being too far away or too close to focus on. The automatic focusable distance with the adapter lens attached is within 24 and 32 cm. Without the adapter lens, the range is 80 cm to .
- Object in a dark area.
- The background is too bright.
- Image containing several objects at the same time; some objects being close to the lens of this unit and others being far away.
- Very shiny or glassy surface
- Repetitive horizontal or vertical lines
- Object reflecting a strong beam.

8 You see the image on the TV or monitor.

- To use versatile image control features, see pages 20 through 22.

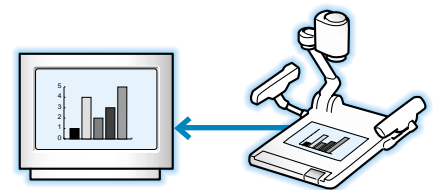

For SVP-5500DX, to change the object projected during presentation, freeze the image on the screen using **FREEZE** button of the presenter then change it. To cancel the freezing, press **EXT** button on the remote control.

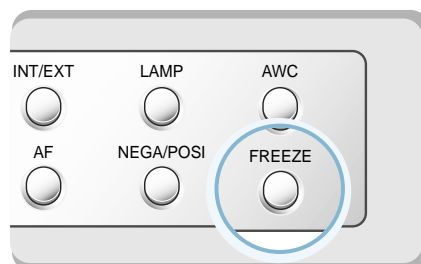

Adjusting your image

Use the control buttons on the remote control or on the control panel of the presenter to adjust the projected image. Some of the main features are described below:

Adjusting image size

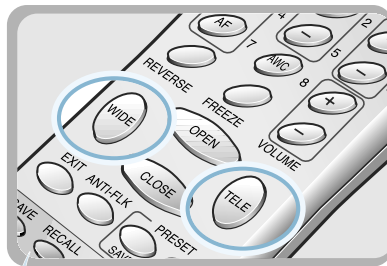
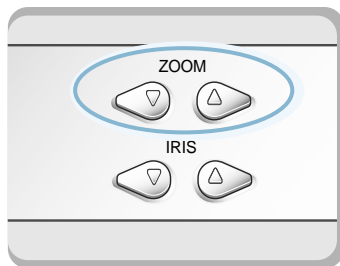

Press **WIDE** or **TELE** button on the remote control to reduce or enlarge the image size displayed on the screen.

You can also use **ZOOM** ▲ or **ZOOM** ▼ button on the control panel of the presenter to achieve the same result.

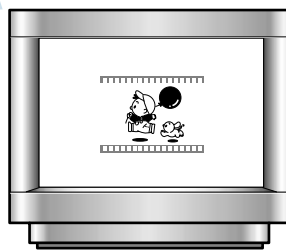

WIDE

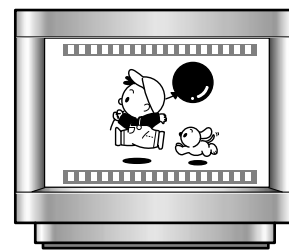

TELE

Adjusting brightness

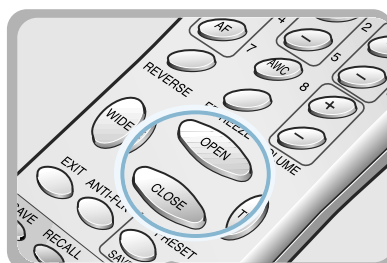
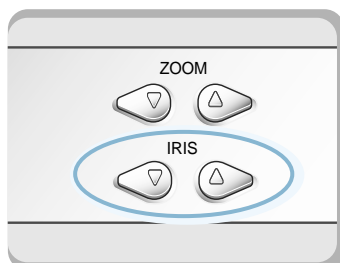

Press **IRIS** ▲ button on the control panel or **OPEN** button on the remote control to lighten the overall image.

Press **IRIS** ▼ button on the control panel or **CLOSE** button on the remote control panel to darken the overall image.

Adjusting image color

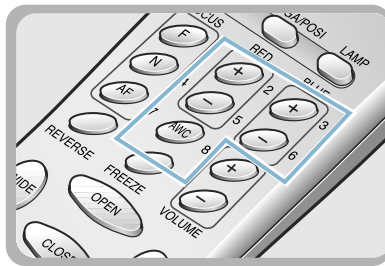
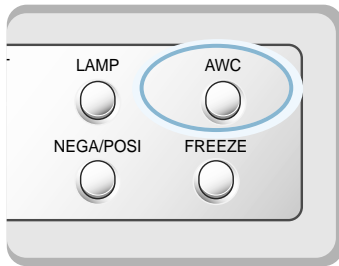

For automatic color adjustment, press **AWC** button.

If you want to fine adjust, press **BLUE +/-** or **RED +/-** button to increase or decrease blue or red color factor manually.

Hint:

To obtain best result, put the camera lens facing the white paper and press **AWC** button.

The color level chosen will be displayed.

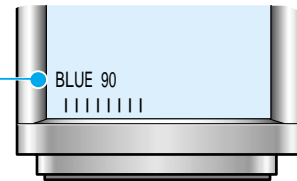

Positive and negative switching

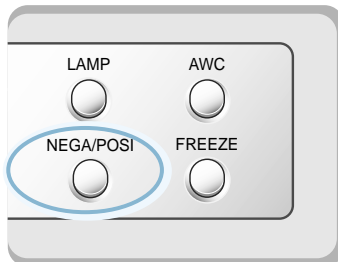

Press **NEGA/POSI** button. Each time you press the button, **POSI** or **NEGA** appears alternately on the screen. Set to **POSI** to see normal object and set to **NEGA** to see negative film.

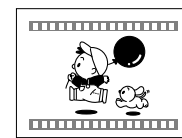

Positive

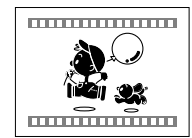

Negative

Rotating image



Press **REVERSE** button to turn the image upside down. This button is available only on the remote control.



Normal image

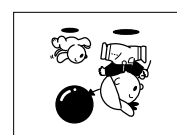

Reversed image

Saving image in memory (for SVP-5500DX only)

You can save the image up to 8 frames into your video presenter's memory. After saving you will be able to recall it.

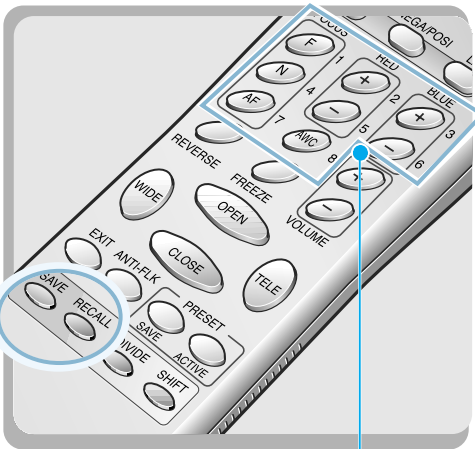

If you turn the power off, all the saved images will be lost.

To save the image into the memory, press **SAVE** button and specify the memory location within 4 seconds using the number keys from 1 through 8.

If you want to recall the saved image from memory, press **RECALL** button and press the memory location number within 4 seconds. If you press and hold down **RECALL** button, all images saved in memory are displayed one by one.

If you want to exit from the recall mode, press **EXIT** button.

The memory location numbers are printed on the right side of these buttons. For example, if you want to save the image into memory location 7, press Save then press AF button printed 7 at right side.

Screen divide and image shift (for SVP-5500DX only)

You can see both the image of an object currently projected and the image saved in memory simultaneously on one screen.

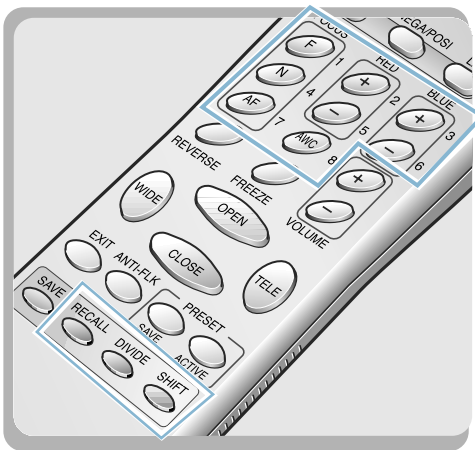

Press **DIVIDE** button and press the memory location number within 4 seconds to recall the image you want to see.

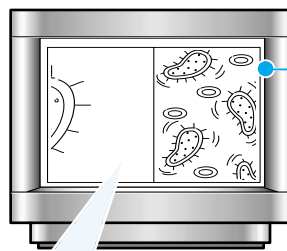

You can see the image of an object currently projected at right side.

The recalled image from memory appears at left side. Press **SHIFT** button to shift the image from the left to right. Each time you press the button, a quarter of the image will be moved from the left to right.

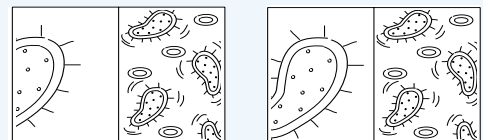

To cancel this mode and return to normal mode, press **EXIT** button.

Saving custom user settings *(for SVP-5500DX only)*

After you adjust feature value, you can save the value for next time use. You can save up to 8 different custom user settings.

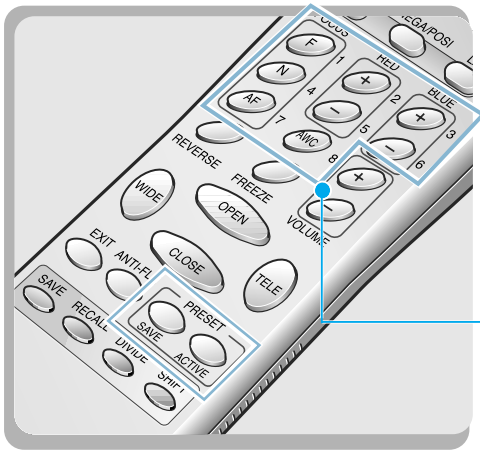

To save the current value, press **Save** button and specify the memory location within 4 seconds using the number keys from 1 through 8.

To recall your custom setting, press the **Recall** button and press the memory location number within 4 seconds.

The memory location numbers are printed on the right side of these buttons. For example, if you want to save the image into memory location 7, press **Save** then press **AF** button printed 7 at right side.



Note You can not save the setting on the **REVERSE**, **FREEZE**, **RECALL**, **DIVIDE** buttons.

Reducing flicker

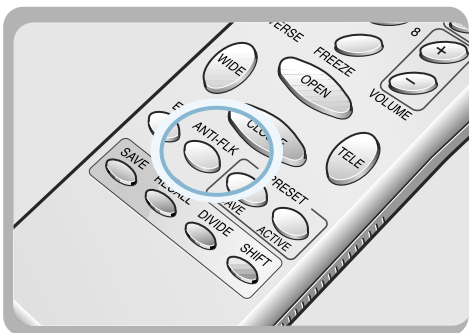

If your monitor screen flickers, press **ANT-FLK** button. It will reduce the flicker on the screen.

Optional accessories

LCD monitor

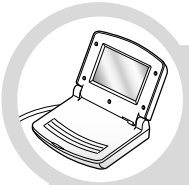

This desktop LCD monitor allows you to monitor the image projected through your video presenter.

The same image is displayed on the TV or projector connected to this unit.

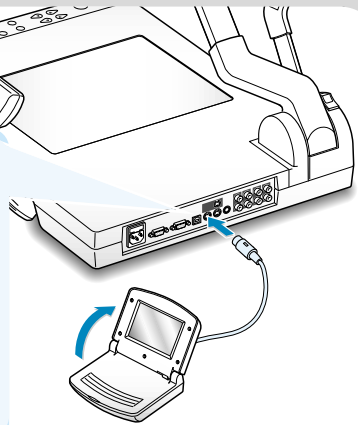
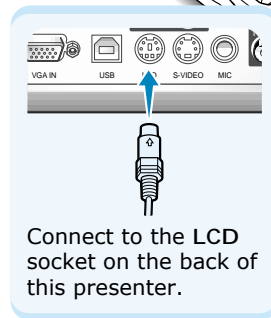

Sub camera



In addition to a main camera, your video presenter offers a small but very useful sub camera as an option.

This camera gives you the great ability to shoot precise angles and close up images even from a microscope.

Connect to the SUB CAMERA socket on the back of this presenter.

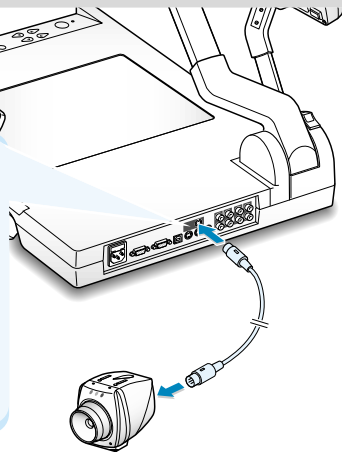
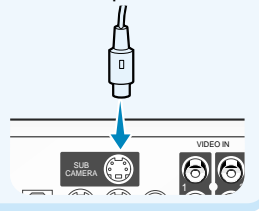

Hold the camera as shown and shoot object freely.

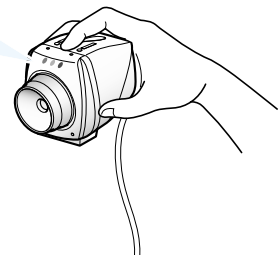

Storage

- 1** Turn the power off and unplug the power cord.

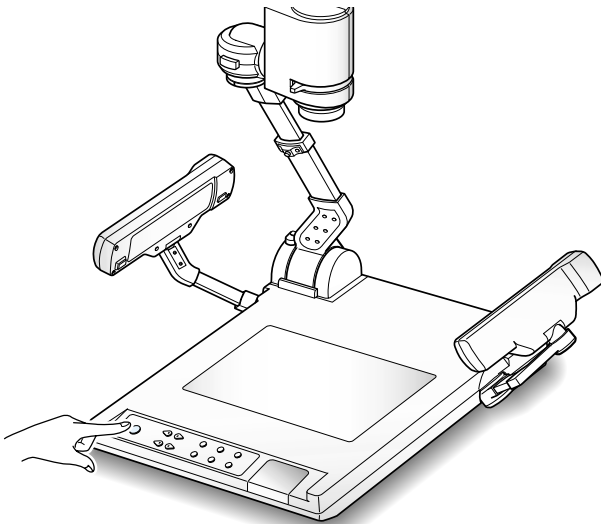

- 2** Attach the lens cap.

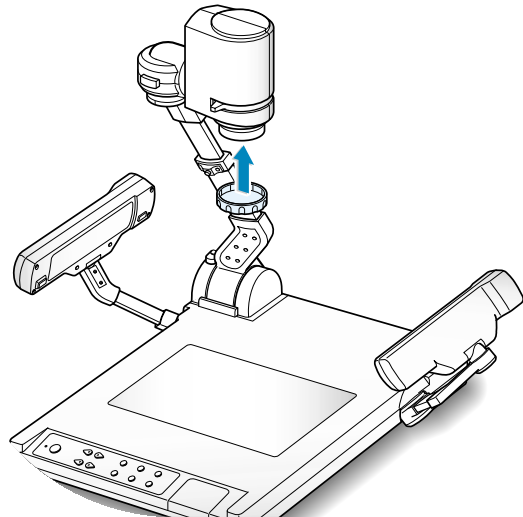

- 5** While you pull the main lock button toward the front of the presenter, fold the head completely.

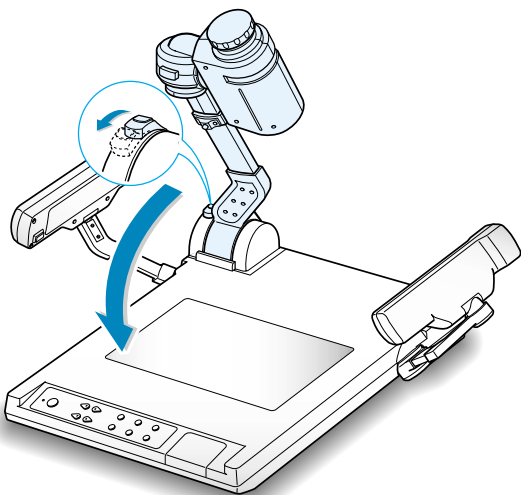

- 6** Fold the lamps on both sides completely.

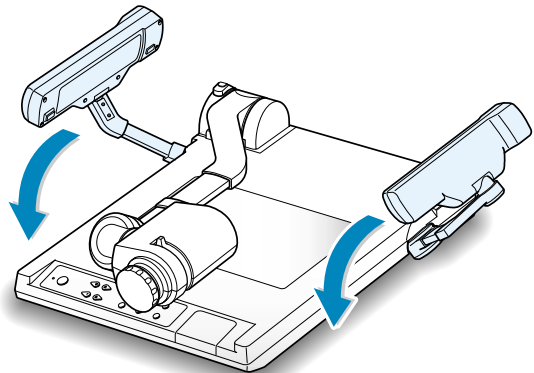

3

Turn the head upside down.

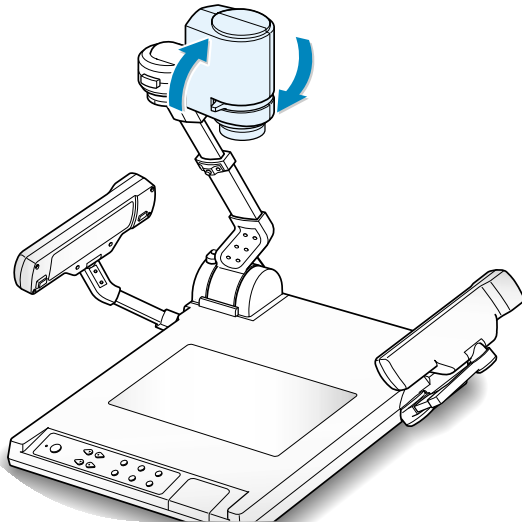

4

While you hold the arm lock button, lower the arm completely.

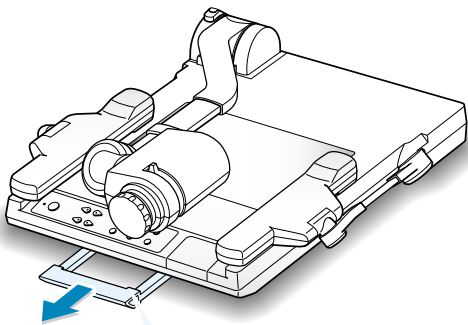
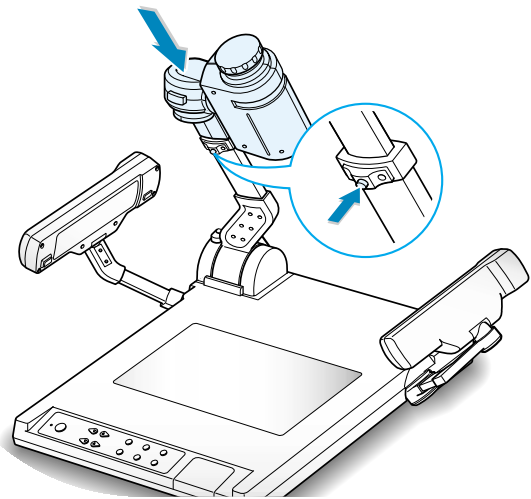

Use the handle when you move it.

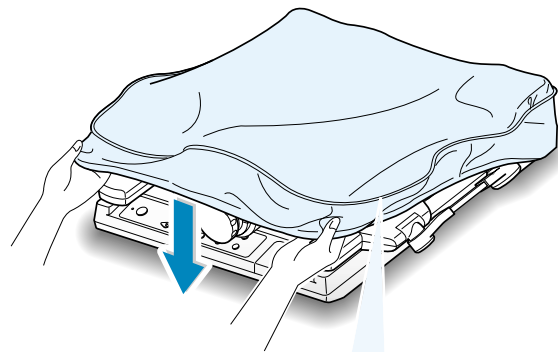

When you do not use it for a long time, protect it with the cover supplied.

Troubleshooting

Sometimes problems can be easily solved by checking a few basic things. Check below before you call for help or take your video presenter to an authorized service center.

Q

Picture is not displayed.

- A
- Check that the brightness is proper. Adjust the brightness if necessary. See page 19.
 - Check for the video cable connection.
 - Check that the built-in fuse is blown.
 - Check that the lens cap is removed.

Picture is not focused on properly.

- Check that the proper lens is attached to the camera.
- Press **AF** button to use automatic focusing feature.
- Check that the object is not too close.

Picture of a slide or a negative film is not displayed.

- Check that an lightbox lamp turns on.
- Check that the camera lens faces the object.
- Check that a proper lens is attached to the camera.
- Check that you set to **NEGA** or **POSI** properly by pressing **NEGA/POSI** button.

PC does not communicate using USB.

- Make sure that **SVP-5500** program is properly installed on the PC.
- Make sure that the OS is **Windows 98**. The program does not operate on **Windows 95**.
- For further details, refer to the **User's Guide** came with the program.

Replacing fuse

1. Remove the fuse holder on the back of this unit using a screw driver.

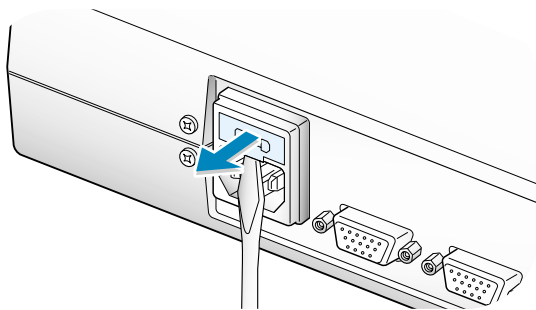

2. Remove the blown fuse and replace it with a spare one.

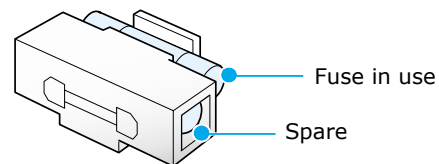

3. Replace the fuse holder.

Q

The presenter does not respond to the remote control.

- Check the batteries in the remote control. If they are used up, replace with new ones. See page 6 to install the batteries.
- Remove the batteries from the remote control if it will not be used for a month or more. This will help prevent possible damage from battery leakage. If leakage occurs, wipe up the liquid inside the compartment and replace the batteries with new ones.

A

Head lamp does not light up as soon as the LAMP button is pressed.

- Built-in protection circuitry is activated to protect the lamp circuit. It's normal.

Specifications



Specifications are subject to change without notice.

Specifications		Description
Optical system	Lens	F1.4~2.7 f=3.9~62.4, 16 X POWER ZOOM
	Shooting area	Max : 213 x 283mm, Min : 14 x 17.5mm
	Focus	Powered (one-touch auto focus)
	IRIS	Auto (with fine level adjustment)
Illumination system	Upper	• Side arm type
	Lower	• Built-in light box
Image	NTSC	Pickup device: 1/4 " 410,000 pixels IT CCD Total pixels: 811 (H) x 508 (V) Effective pixels: 768 (H) x 494 (V)
	PAL	Pickup device: 1/4 " 470,000 pixels IT CCD Total pixels: 795 (H) x 596 (V) Effective pixels: 752 (H) x 582 (V)
	SYNC system	Internal SYNC
	Resolution	450 TVL
	White balance	Manual / AWC (one-touch)
	S / N ratio	46 dB or more
	Video output	• C-Video (VBS 1.0 Vp-p/75Ω unbalance) • S-Video (Y : 1.0 Vp-p/75Ω unbalance, C : 0.3 Vp-p/75Ω unbalance)
	Positive/Negative switching	Available
	Remote control	Supplied
	Input selection	4 (5 [*]) Channels (Internal 1, External 3 (4 [*]))
	On-screen display	Available
	Image rotation	• MECHANICAL (180° MAX) • ELECTRICAL (180°)
	Image freeze	Available [*]
	Image save	Available (8 Frames) [*]
	Image recall	Available (8 Frames) [*]
	Image divide	Available [*]
	Image transfer to computer	Available (USB : full, 1/4, 1/16 mode) [*]
	Application software	Windows application in Windows 98 or later
	Scan converter	Built-in (640 x 480, 800 x 600, 1024 x 768 : 3 Modes) [*]
	Preset function	Up to 8 user settings
Input terminal	Video (RCA/75Ω) X 2, Audio (RCA) X 2, VGA (15 pin D-sub) [*] X 1, MIC (6.3 jack/optimal impedance 600Ω, 65dB) X 1	
Output terminal	Video (RCA/75Ω) X 2, S-Video (MINI DIN 4P CON./75Ω) X 1, Audio (RCA/optimal impedance 10KΩ or more, -10dB) X 2	
PC interface	Built-in USB [*] and RS-232C	
General	Operating temperature/Humidity	+5 °C ~+35 °C / 30% ~ 90%
	Power	AC 100V ~ 240V, 50/60Hz
	Dimension (mm)	• In-use: 665(W) x 510(D) x 547(H) • Storage: 495(W) x 510(D) x 167(H)
	Wight	8.3 kg

* SVP-5500 DX only