

Flex Insight XMS All-in-one Computer Monitor Workstation

38963	36" single workstation with lock
38961	36" single workstation
38967	72" double workstation with lock
38966	72" double workstation

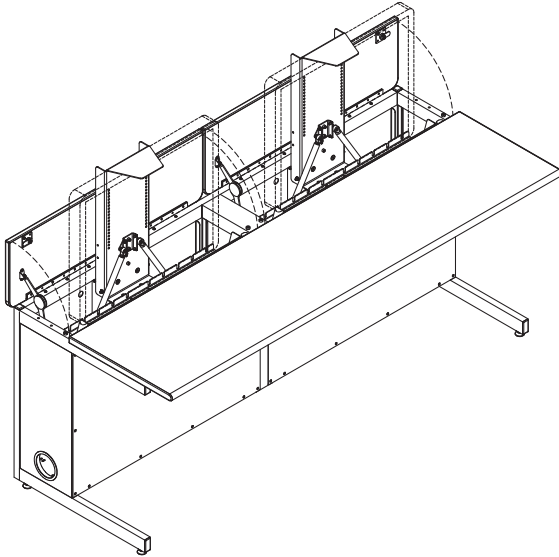

72" Flex Insight XMS double workstation with locking lid

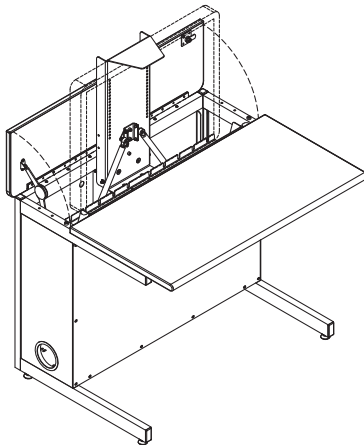
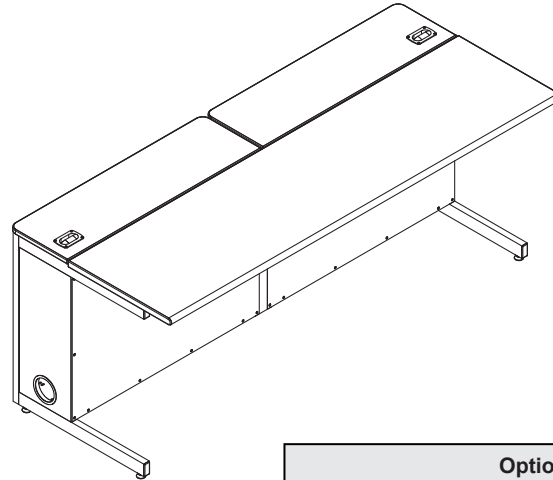

36" Flex Insight XMS workstation with locking lid

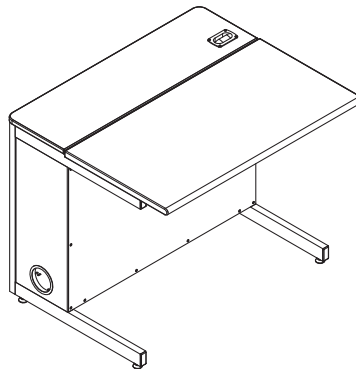

The graphics and capabilities of large all-in-one computers are amazing. However, such technology takes up valuable desk space and makes communicating with students difficult. Wouldn't it be wonderful if you could make the large screens disappear when you really need to get the classroom's attention? With Spectrum's Flex Insight Extreme Monitor System Desks, you can change from computer instruction to traditional instruction in seconds. With classroom space at a premium, doesn't it make sense to get the most out of technology by being able to transform a computer lab into a study or lecture room? Now it can be done with Spectrum Flex Insight Extreme Monitor System Desks.

Page 7 **Options & Accessories**

Color Options

Standard laminate / color combinations

Wild Cherry / Black (CHB)



Indigo Organix / Black (IB)



Fusion Maple / Black (FMB)



White Fiesta / Cool White (WFCW)

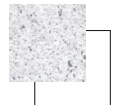

Indigo Organix / Cool White (ICW)



Standard color combination refers to the quickest deliverable product color combination. Custom laminates and color combinations are available-additional lead-times and up-charges may apply. Call 1-800-235-1262 for further information.



205 Westwood Ave, Long Branch, NJ 07740
Phone: 866-94 BOARDS (26273) / (732)-222-1511
Fax: (732)-222-7088 | E-mail: sales@touchboards.com

Features and Benefits

- Desk allows any classroom to be reconfigured from a lecture hall to a computer training lab in seconds
- Manually-actuated monitor column with pneumatic cylinder assist allows the monitor to be moved up when needed, and retracted with the lid closed to convert the desk to a conventional student desk
- Large monitor storage compartment protects and secures an all-in-one computer monitor, with keyboard and mouse storage
- Easy lift mechanism provides a nominal 16" of vertical lift above the table worksurface to eye level provides ergonomic viewing angle
- Proven triple ball bearing rail lift column design provides smooth operation, reliability, and long life
- Built in lift / lower handle is used to lift and lower so monitor is not damaged
- Supports select monitors from 18.5" to 24" diagonal, weighing between 14-32 lbs. See p.3 for compatibility. (Desk does not fit 21" iMacs)
- Included VESA mounting bracket works with standard 75mm and 100mm VESA monitor mounts or iMac. (Some iMacs require an Apple VESA mount adapter)
- Available in locking or non-locking monitor compartment versions
- Slots provided below monitor provide easy securing of wires and cables
- Friction dampener on monitor lid provides support and dampening, and slows the lowering of the lid, keeping hands and fingers safe
- Cord channel conveniently keeps computer wires and cables out of the way, and is wide enough to accept most power strips
- Large, 4" side-panel cord management grommets create a continuous cord channel when desks are placed side-by-side
- Adjustable CPU sling with heavy-duty adjustable straps for CPU storage will fit 4" to 8-1/2" wide computer towers up to 20" high x 18" deep
- Superior cord management and wire loom protects wires and cables between monitor and power strip
- Removable rear security panel provides security and easy-access to cables and equipment (secured with 4mm JC bolts and hex wrench)
- Scratch and impact-resistant, high-pressure laminate worksurfaces (1¹/₁₆" worksurface, 1³/₁₆" monitor lid)
- Ergonomic, bull nose front edge is easy on wrists
- Leveling glides keep desk level on uneven surfaces
- Durable powder coated steel chassis
- Quick-connect unit-to-unit brackets allow desks to be connected together
- All wires are protected from student-access to prevent tampering
- Warranted to be free of all defects in materials and workmanship with a 10-year warranty (1-year on pneumatic lift cylinder)

Construction

- The worksurface is constructed from 1¹/₁₆" (1³/₁₆" monitor lid) (thick NAUF (No Added Urea Formaldehyde) composite board with .030 high-pressure laminate, and a balancing phenolic backer on the bottom side. The left and right edges are finished with 3mm vinyl edge-band.
- The monitor compartment lid worksurface is constructed from 3/4" thick industrial-grade composite board with .030 high-pressure laminate on both sides-all edges are finished with 3mm vinyl edge-band
- Welded, 16-gauge 1" x 2" rectangular steel tube legs
- Upper leg panel, 14 gauge
- All metal components are finished with a scratch-resistant powder coat epoxy paint
- Each Flex Insight XMS Desk is factory-assembled, packaged and shipped on its own skid

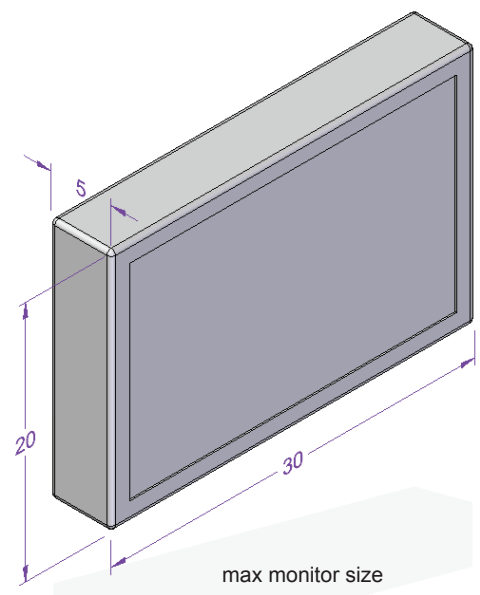

Specifications

Lift mechanism	manually-actuated with pneumatic spring-assist
Lift capacity	14-32 lbs (factory preset)
Maximum all-in-one computer monitor size	30"W x 20"H x 5"D
Lower wiring tray for power cords and power strips	32"W x 9 ³ / ₈ "D x 3 ⁷ / ₁₆ "H
Lower wiring tray power cutouts	5"W x 3 ¹ / ₈ "D (2 per tray)
ADA-compliance*	knee clearance: 33 ³ / ₈ "W x 19"D x 28"H (1 person per desk) <small>*Minimum ADA guidelines for knee clearances are 30"W x 19"D x 27"H</small>
Unit weight (nominal)	107 lbs - 38961, 38963 (36"W) 206 lbs - 38966, 38967 (72"W)
Shipping weight (nominal)	144 lbs - 38961, 38963 (36"W) 277 lbs - 38966, 38967 (72"W)
Meets or exceeds applicable ANSI-BIFMA test standards	

Specifications subject to change without notice

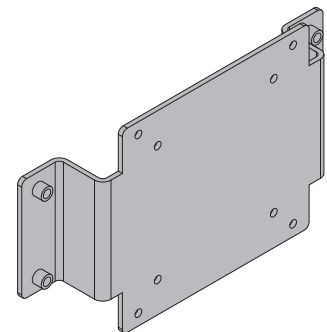

Spectrum VESA bracket included with desk (formerly 38969)

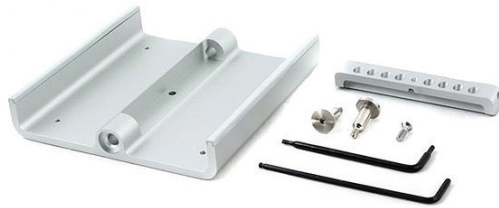

“Apple® VESA mount adapter”
not included with desk
 Apple product # **M9649G/A** or **MD179ZM/A**
 (contact Apple dealer)

Note: As of 12/10/13, all iMacs made by Apple from Jan. 2013 - Dec. 2013 will work with this desk.

Note: To install a pre-2012 iMac in the XMS desk, customers must purchase “Apple VESA mount adapter” for 24” or 27” iMacs.

The Apple adapter is only available from Apple and is not included. See website or chart below for iMac compatibility.

How to identify iMac models:
<http://support.apple.com/kb/HT1758>

XMS desk / iMac compatibility* / weight information				
iMac model / version	XMS desk compatible		weight	counterbalance weights needed <i>(kit includes two 2.5 lb weights)</i> 38965
	Yes	No		
20" iMac (pre-2013)		✓		
21" iMac (pre-2013)		✓		
21.5" iMac (Jan. 2013 - Dec. 2013) <i>(will also work with standard Flex Insight desk)</i>	✓		11.5 lbs	use 4 weights <i>(requires 2 kits)</i>
21.5" iMac (pre-2013)		✓		
24" iMac (aluminum & glass)		✓		
24" LED Cinema Display	✓		21 lbs	use 2 weights
27" iMac (Jan. 2013 - Dec. 2013)	✓		19.2 lbs	use 3 weights <i>(requires 2 kits)</i>
27" iMac (2012)		✓		
27" iMac (late 2009 - early 2011)	✓		27.6 lbs	not required
27" LED Cinema Display	✓		23.6 lbs	use 2 weights
27" Apple Thunderbolt Display	✓		23.5 lbs	use 2 weights

*as of 12/2013 - for reference only - check with Apple dealer for complete iMac info

- Included with desk:
- Deluxe internal heavy-duty metal keyboard / mouse tray
 - 4mm hex wrench for instructor-access
 - Two keys are included with each lock (locking desks only)
 - Wire loom for keyboard, mouse, and monitor cables protect cable from pinching
 - Rubber keyboard tray pads (protect keyboard)
 - One unit-to-unit bracket (desks must be same height to connect)

Note: This desk is not compatible with 21" iMacs

36" Flex Insight XMS All-in-one computer monitor workstation with locking lid (shown in extended position)

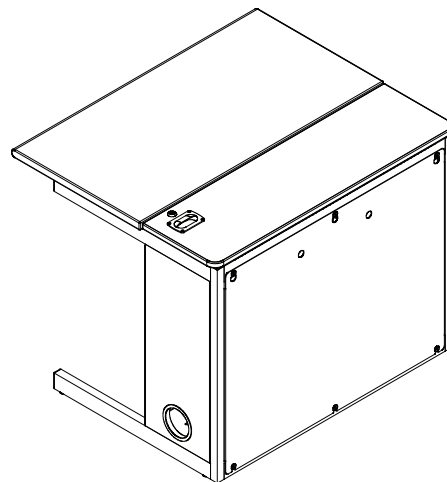
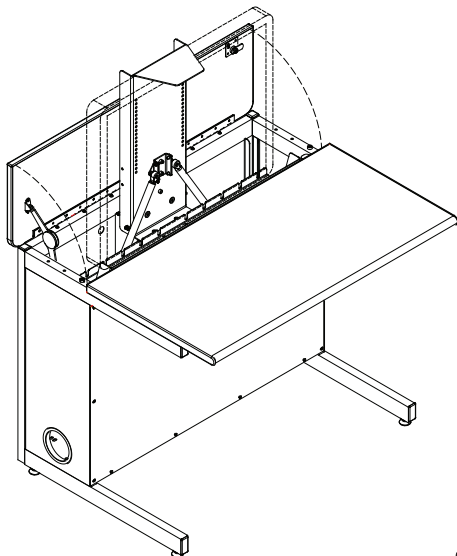
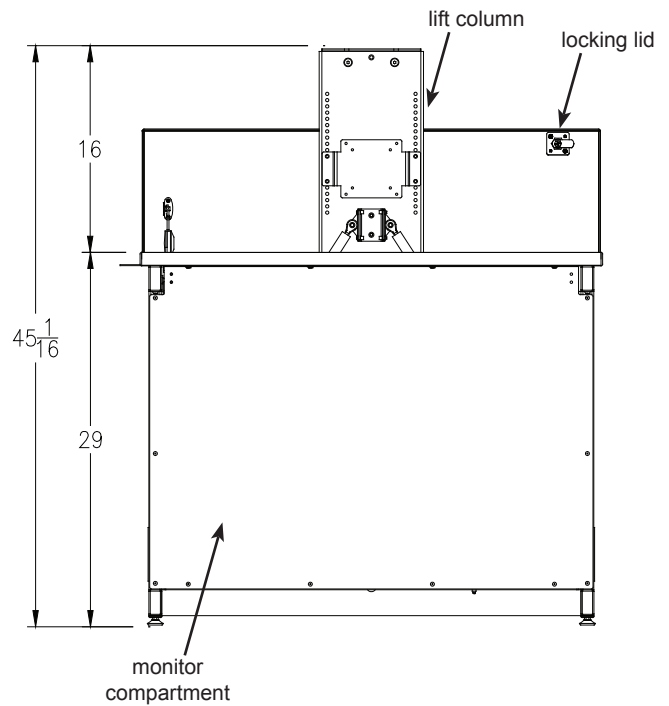
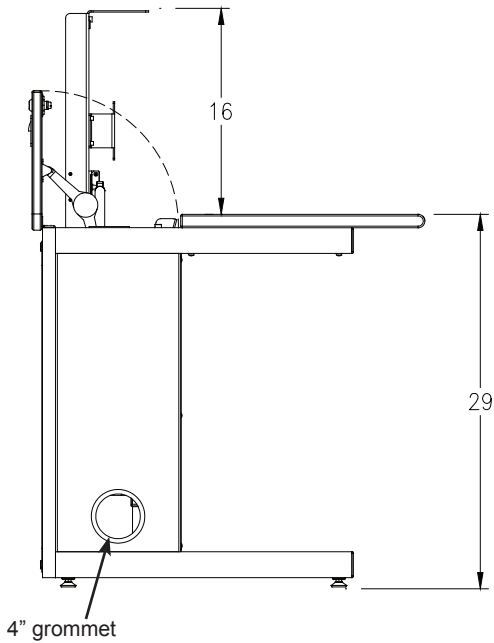
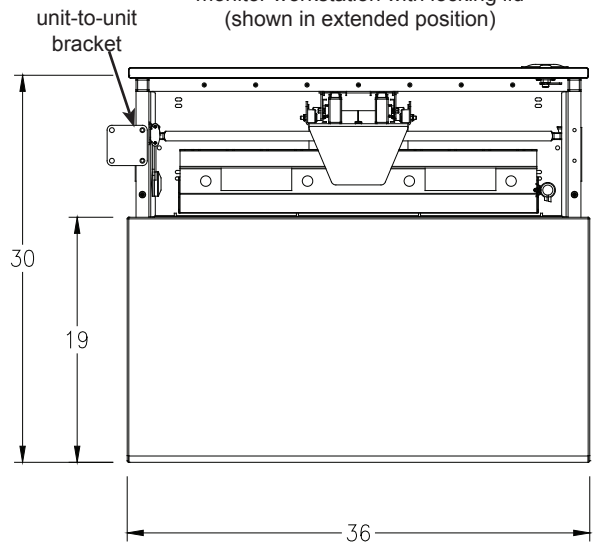

72" Flex Insight XMS All-in-one computer monitor double workstation with locking lid (shown in extended position)

unit-to-unit bracket

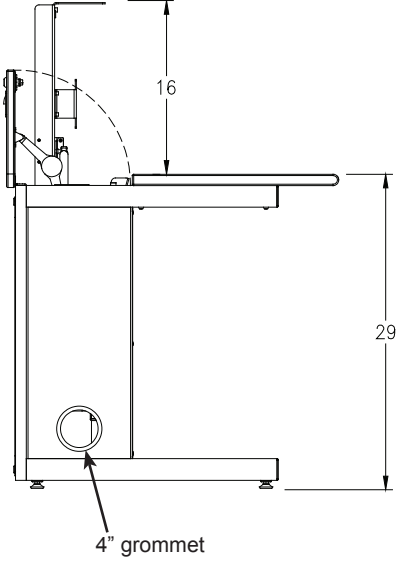
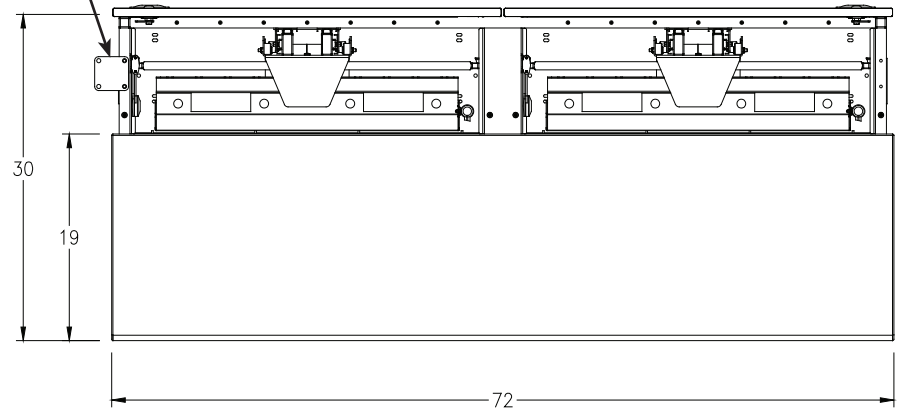

locking lid

(2) lift columns

locking lid

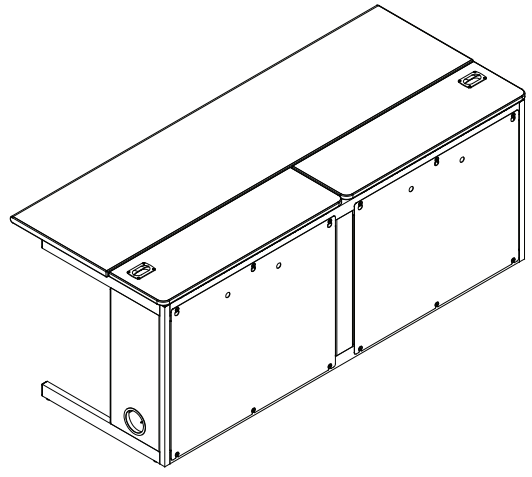
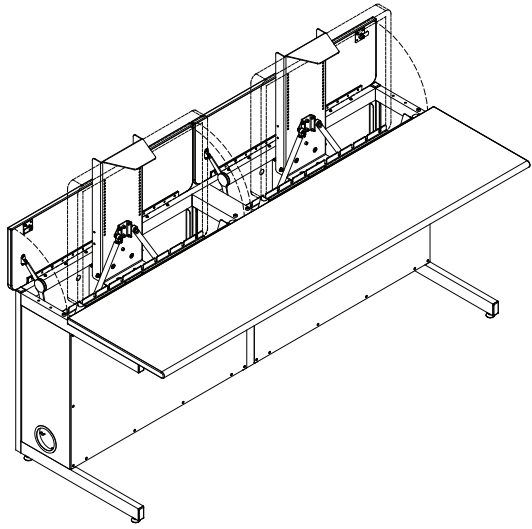
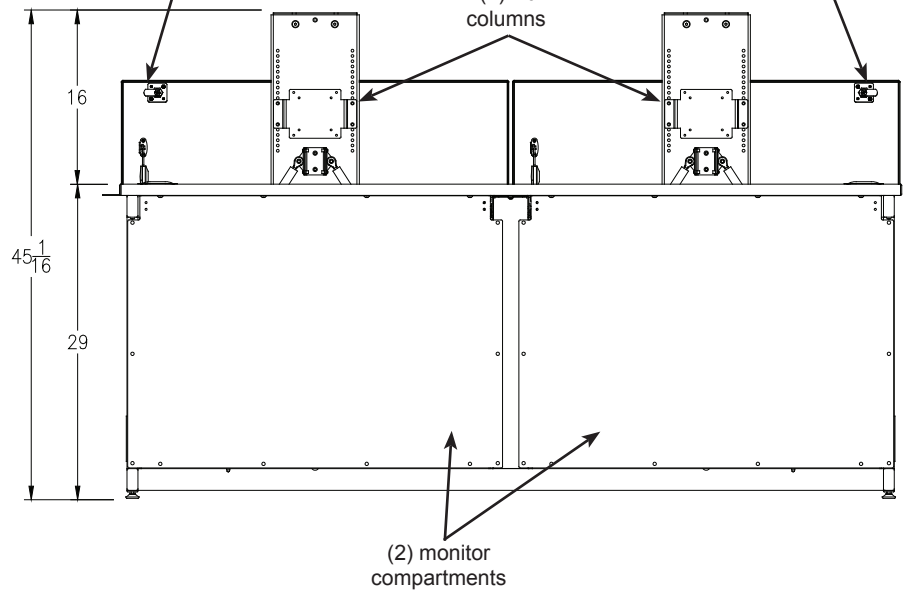

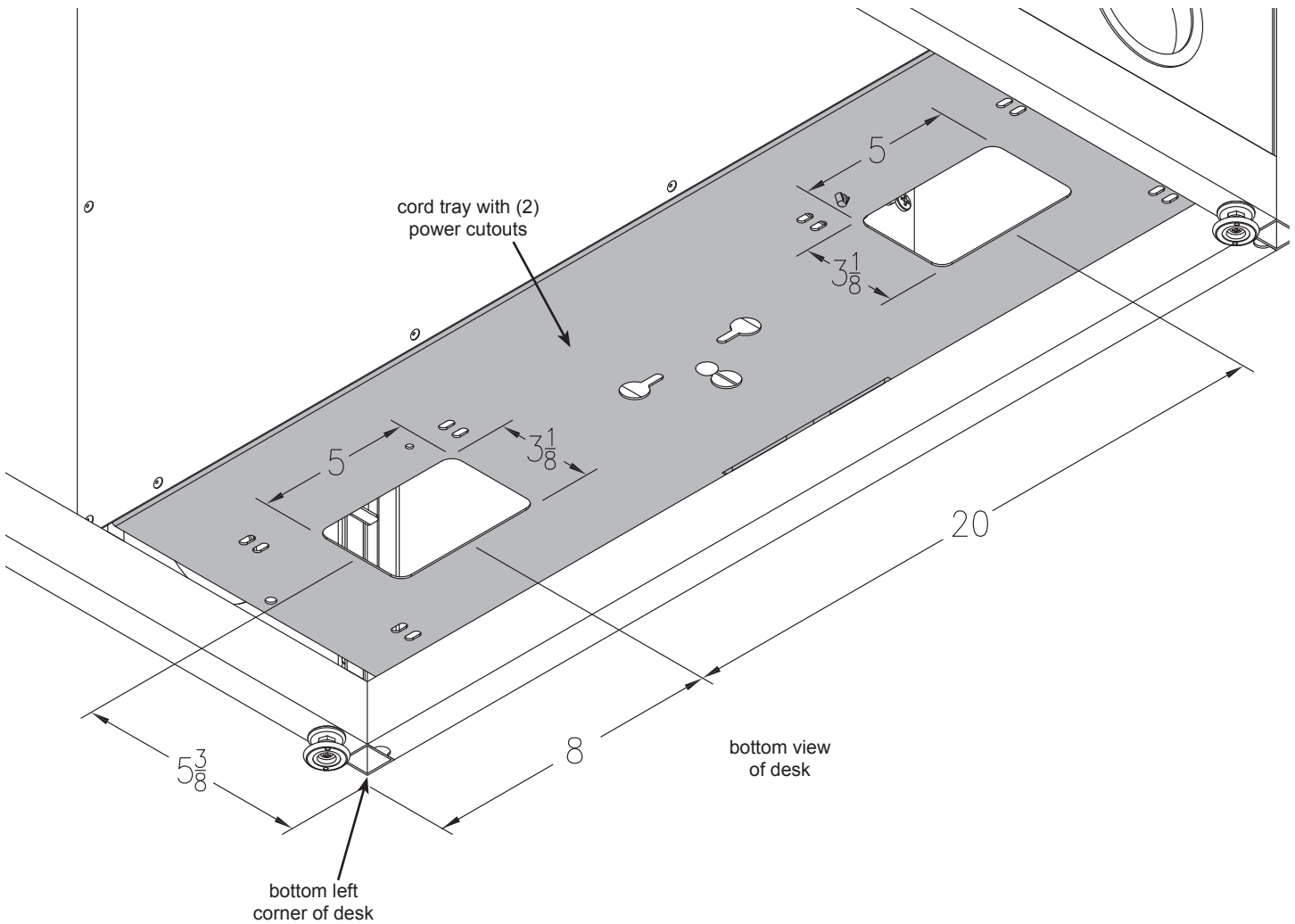
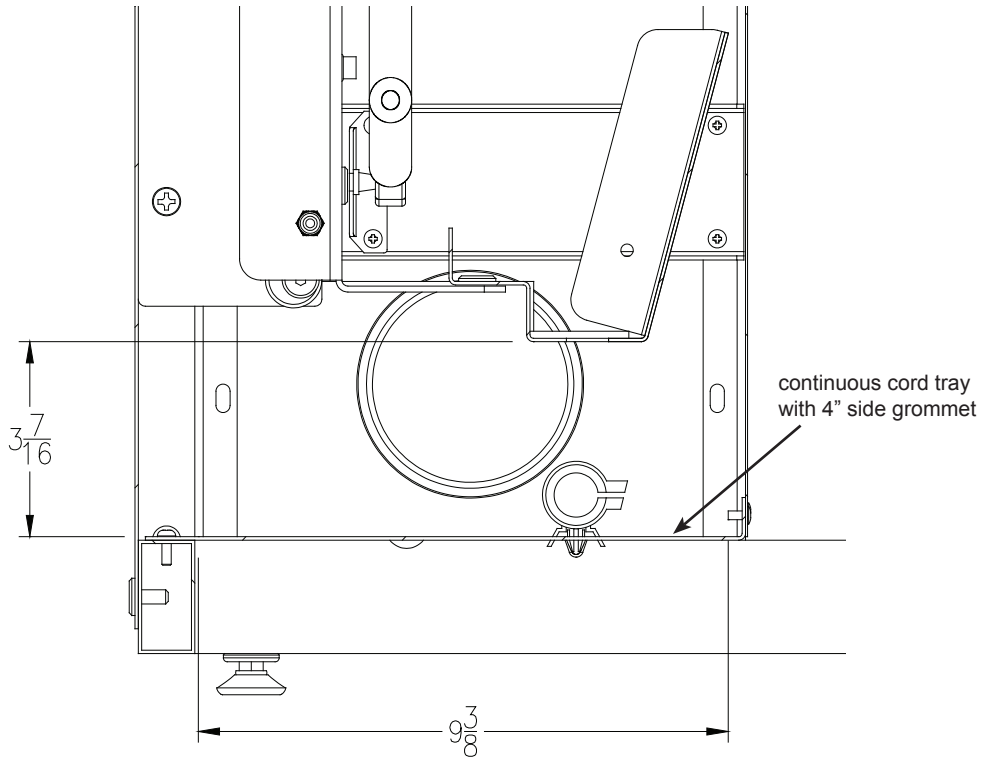

Options



“Apple® VESA mount adapter”
not included with desk
 Apple product # **M9649G/A** or **MD179ZM/A**
 (contact Apple dealer)



Monitor Counterbalance Kit
 (for lighter monitors)
 kit includes two 2.5 lb weights
 38965

Note: To install a pre-2012 iMac in the XMS desk, customers must purchase “Apple VESA mount adapter” for 24” or 27” iMacs.

The Apple adapter is only available from Apple and is not included. See website or chart below for iMac compatibility.

How to identify iMac models:
<http://support.apple.com/kb/HT1758>

Nominal weight of all-in-one monitor / iMac	Counterbalance
14-17 lbs	use 4 weights (requires 2 kits)
17-20 lbs	use 3 weights (requires 2 kits)
20-24 lbs	use 2 weights
24-27 lbs	use 1 weight
27-32 lbs	not required

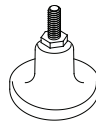

1” Bell Glide Riser Kit
 raises worksurface height from
 29” to 30” (set of 4)
 98513

Warranty

WE WILL MAKE IT RIGHT FOR YOU!

Spectrum is committed to provide complete customer satisfaction. Each of our products is manufactured from the best materials available and each product is stringently monitored throughout the production process through our P.A.C.E. program (Product Assurance to meet Customer Expectations).

We expressly warrant that Spectrum products will be of good quality and workmanship and free from defect for the period set out in the warranty table below from the date of delivery. This warranty shall not apply to defects or damage resulting from misuse, abuse, neglect, improper care, modification or repair not authorized by Spectrum, or any other cause outside the control of Spectrum. Spectrum will, at its sole option, either repair or replace the defective product.

This warranty is exclusive; no other warranty, written or oral, is expressed or implied. This warranty is given by Spectrum to Buyer and to no other person or legal entity. No Spectrum dealer, distributor, agent or employee is authorized to make any modification or addition to this warranty.

NOTWITHSTANDING ANYTHING TO THE CONTRARY, SPECTRUM WILL NOT UNDER ANY CIRCUMSTANCES BE LIABLE FOR INDIRECT OR LIQUIDATED DAMAGES, INCLUDING CONSEQUENTIAL, INCIDENTAL AND SPECIAL DAMAGES. IN NO EVENT SHALL SPECTRUM'S LIABILITY, WHETHER UNDER CONTRACT OR WARRANTY, IN TORT OR OTHERWISE, EXCEED THE PURCHASE PRICE RECEIVED BY SPECTRUM FOR THE PRODUCT AT ISSUE AND "RECALL ACTION" EXPENSES. SPECTRUM SHALL NOT BE SUBJECT TO ANY OTHER OBLIGATIONS OR LIABILITIES, WHETHER ARISING OUT OF BREACH OF CONTRACT, WARRANTY, TORT (INCLUDING NEGLIGENCE AND STRICT LIABILITY) OR OTHER THEORIES OF LAW, WITH RESPECT TO PRODUCTS SOLD OR SERVICES RENDERED BY SPECTRUM, OR ANY UNDERTAKINGS, ACTS OR OMISSIONS RELATING THERETO.

Our Customer Service Department is ready to provide immediate attention to any questions, comments or concerns. They are available to answer your calls Monday through Friday from 7 am to 5 pm CST. In addition your product comments or concerns are welcome via e-mail at: spectrum@spectrumfurniture.com.

Warranty Table

Item	Warranty Period
<ul style="list-style-type: none"> Adjustable Crank/Electric Desk Legs Flat Panel Desk Gas Cylinders 	<ul style="list-style-type: none"> 1 Year
<ul style="list-style-type: none"> Adjustable Height Chair Parts – including frames, gas cylinders, wood and plastic parts, and control handles Adjustable Height Chair Parts Casters Adjustable Height Chair Upholstery In-Stock Upholstery Graded-In Fabrics and Customer Owned Material 	<ul style="list-style-type: none"> 7 Years 2 Years 2 Years No Warranty
<ul style="list-style-type: none"> Height Adjustable Columns and Lifts General Use Casters Electrical Keyboard/Mouse Trays 	<ul style="list-style-type: none"> 1 Year
<ul style="list-style-type: none"> Flat Panel Monitor Arm – General Parts Flat Panel Monitor Arm – Gas Cylinders 	<ul style="list-style-type: none"> 5 Years 2 Years
<ul style="list-style-type: none"> Computer Desk Chassis Cart Chassis Lectern Chassis 	<ul style="list-style-type: none"> 10 Years

